

AOYAMA ELEVATOR GLOBAL LTD.

CONTACT INFORMATION

Japan Headquarters Address:

2-2-15 Minami-aoyama, Minato-ku, Tokyo, Japan.

Japan Factory Address:

No. 17, Osukannon, Nagoya Southwest District, Aichi Prefecture, Japan.

Tel: +81 52 4564462

Global Bussiness Center Address:

UNIT 04,7/F BRIGHT WAY TOWER,NO.33 MONG KOK RD KL, HongKong.

Email: info@aoyama-elevator.jp

Web: www.aoyama-elevator.jp

The printed products are for reference only. The Company reserves the right to change product design and specifications. The printed matter contained information on the suitability of the products are extremely special purpose, merchantability, quality or any procurement terms of the agreement is not long enough to guarantee or commitment of any kind, express or implied.

印刷された製品の基準のためであるだけです。同社製品の設計を変更するには、右と仕様を保有します。印刷物の製品の適合性についての情報が含まれている非常に特別な目的で、市場性、品質または契約のいずれかの入手を保証またはいかなる種類の関与を十分に長くない、明示的または黙示的。

AOYAMA PLAN T115 3259158 Z2

The Best elevator from Japan
日本のベストエレベーター

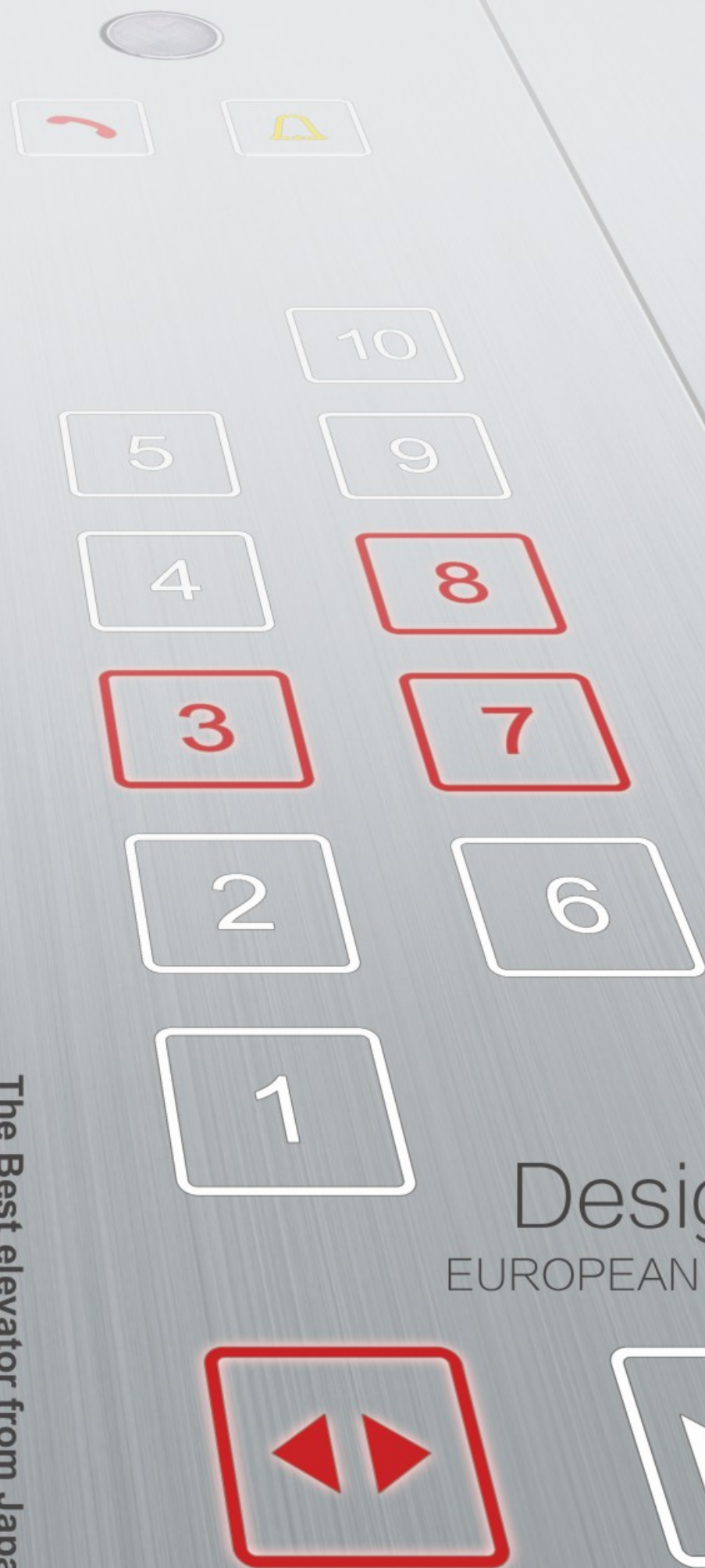

AOYAMA
AOYAMA ELEVATOR GLOBAL LTD.
ELEVATOR

Designed to
EUROPEAN STANDARDS



Excellent quality Serve the world
優れた品質世界のサーブ

Intelligent transportation Solutions expert
インテリジェントな交通案
専門家を解決する

Catalog カタログ

03 | 04

Enterprise Introduction

05

AOYAMA ELEVATOR policy
青山のエレベーターの政策

06

Core Technology
コア技術

07 | 10

Small machine room passenger elevator

11 | 14

Escalator & Moving walk Configuration
無機房の乗客エレベーター

15 | 24

Customized Design
カスタマイズされたデザイン

25 | 30

Villa Elevator
別荘エレベーター

31 | 32

Panoramic elevator
観光エレベーター

33 | 34

Bed Elevator
病床のエレベーター

35 | 37

Freight elevator
貨物輸送エレベーター

38

Dumbwater Elevator
雑物エレベーター

39 | 40

Car Elevator
自動車エレベーター

41 | 44

Elevator Function
エレベーター機能

45 | 46

Escalator
エスカレーター

47 | 48

Moving walk
自動歩道

49 | 51

Escalator & Moving walk Configuration
エスカレーターと自動歩道の配置

52 | 54

Layout specifications and dimensions
レイアウト仕様とサイズ

55 | 56

Modernization Packages
近代化のパッケージ

57 | 60

Reference Projects
工事の事例

AOYAMA ELEVATOR GLOBAL LTD. is a professional elevator company who designs and manufactures complete elevators, escalators and moving walks, as well as elevator parts. The company covers a land area of over 80,000 square meters with more than 35,000 square meters of factory houses and 15,000 square meters of office area. Currently, more than 300 employees work for AOYAMA ELEVATOR, which includes 82 engineering technicians.

From design to manufacture, from installation to maintenance, AOYAMA ELEVATOR endeavor to satisfy the clients' individual requirements. Our world-wide service networks, well-trained engineering staff provides the customers with perfect services according to fixed work standard wholeheartedly. AOYAMA ELEVATOR have formulated and implemented a set of strict installation management process and operation rules to ensure our customers rest at ease.

青山のエレベーターの世界的な会社との完全なエレベーターメーカーのデザインプロのエレベーター、エスカレーターと動く歩道、エレベーター部品として。会社の工場の家とオフィス面積15000平方メートル3万5000平方メートル以上で8万平方メートル以上の土地の面積をカバーします。現在では、300人以上の従業員を青山エレベーターのために働く、82工学技術者を含みます。設計から製造への導入からメンテナンスまで、クライアントの個々の要件を満たすために青山昇降するよう努めています。我々の世界的なサービス・ネットワークは、よく訓練された技術スタッフの作業標準の固定による心の完全なサービスを顧客に提供します。青山のエレベーターを持って策定・施行されたセットの厳しいインストール管理プロセスと操作性で我々の顧客の残りを確保するためのルール。



Enterprise introduction 企業紹介

Every year is a safe year.
Every day is a comfortable day.
ELEVATORS are made by man.
No matter what you do,
AOYAMA ELEVATOR always sticks to a basic principle:
Security and Comfort.
Now it is, and it will always be, and always will be.

毎年、安全な年です。
毎日快適な日です。
エレベーターは人によって作られています。
あなたがたとえ何をしても、
私たちは常に基本原則に固執します。
安全と快適さ。
現在では、それが常にそうである、と常に意志があります。

硫酸紙正面

歴史 History

Established in Nagoya since 1966
The most professional elevator supplier in Japan
50 years of elevator design, manufacturing, installation, maintenance experience.
Since now, AOYAMA ELEVATOR is about to serve the people of the whole world.

1966 年以降は名古屋に設立された
日本で最もプロのエレベーター業者
50 年のエレベーターの設計、製造、設置、保守を経験します。
今から、我々のエレベーターは、全世界の人々に貢献するについて

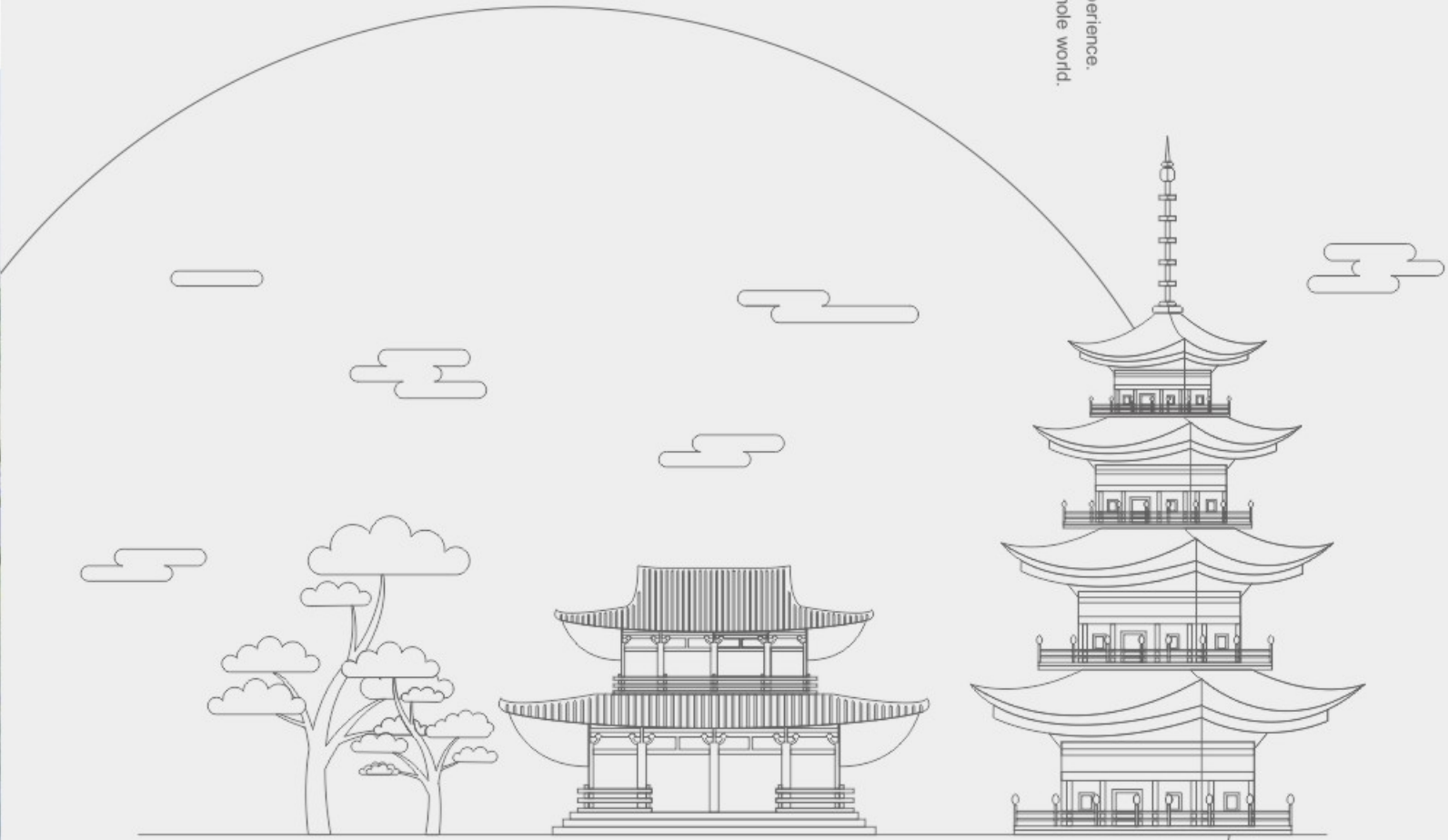

硫酸紙背面



盛

山

コア技術 Core Technology

AOYAMA ELEVATOR focuses on three Japanese core systems that are essential for the reliable of elevator and escalators: Traction system, control system and door operating system.

Having inherited Japanese advanced manufacturing technology and uniformed devises, together with best skills and rigorous and careful working style, ensures the outstanding quality of our products.

Aoyama elevator policy
青島エレベーターの政策

未来の安心を創造し、 今日の万一を解決する。

現代の暮らしに欠くことのできないエレベーター。その“安全”を守ることを使命に、エレベーターは日夜活動しています。

ボタンひとつで操縦できるタテの交通機関のエレベーター。それはその裏で、精密かつ複雑な制御が働いていることの証しです。

心に秘めた固い決意。フェアかつ強力な実行力。不測の事態を予測し、突発的なトラブルに迅速に対応する・・・私たちは設立当初の気持ちを忘れることなく、3つのポリシーを心にきざみ、最善を尽くしています。

FAIR
フェア

もっと公正に、
さらに適正に。

COST
コスト

高い品質を、
どこよりも安く。

HEART
ハート

親密に見えるスタッフが

To create the future of peace, to solve the case.

ELEVATOR is indispensable to modern life. To protect the "safety" mission, working day and night.

Transport of vertical elevator with one button can control. It is in the precise and complex operation of the control card.

Determination of potential. A strong and fair execution. Prediction of unforeseen circumstances, the sudden trouble to respond quickly and we can forget the feeling of the three policy in every heart, and do my best.



 Improve transmission efficiency
25%-35%

 Noise reduction
5-10db

Gearless Traction Machine -YASKAWA

We choose rare earth material and fully combine coaxial transmission technology and digital variable frequency technology with group computer combined control technology. With less running cost & less energy dissipated. Compared with the ordinary and traditional technology, gearless traction machine can save more than 46% of the energy. Gearless traction machine needs no renewal of lubricant. Without grease pollution, low noise, quiet & natural.



低雑音
Low noise



緑色の環境保護
Green environmental protection



効率的な省エネ
Effective and energy-saving



安定して信頼できる
Stable and reliable

Japanese Digital Inverter Technology -YASKAWA

Advanced vector conversion technology, according to human body riding comfort, it will take real-time speed adjustment.

Advanced high-speed digital signal processing system can increase the sensitivity of the speed control of the traction machine which will minimize the elevator vibration. The newest low-noise control technology can make the elevator operates quietly and steadily.

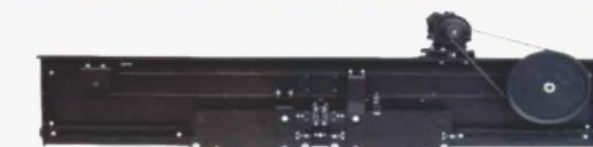

Panasonic Variable Frequency

Panasonic variable frequency door machine can freely adjust door opening/closing speed. It is equipped with self-study function. It internally sets the optimized running curve with the convenient adjustment. It owns the excellent closed loop control, instant control to the running speed and position, traditional travel switch software.



Small machine room passenger elevator 小型機の乗客エレベーター

In order to save the building space, extend the larger space utilization rate of the construction, bring about the more sensitive and reliable running, the more graceful and attractive building, Small machine room passenger elevator applies the compact and concentrative permanent magnet synchronous and gearless traction machine and specially-designed control cabinet. There machine room has same area as that of the well.

建物の空間を節約するために、建物の更に大きな空間利用率を開拓して、実行することはより機敏で信頼できるようにして、ビルがより優雅で美しい、小さい機関の乗客のエレベーターを使用して、コンパクトな密度の永磁の同期の無歯車の誘引機と特殊な設計の制御箱を採用して、機械の面積を井道面と完全に同じに達するようにします。

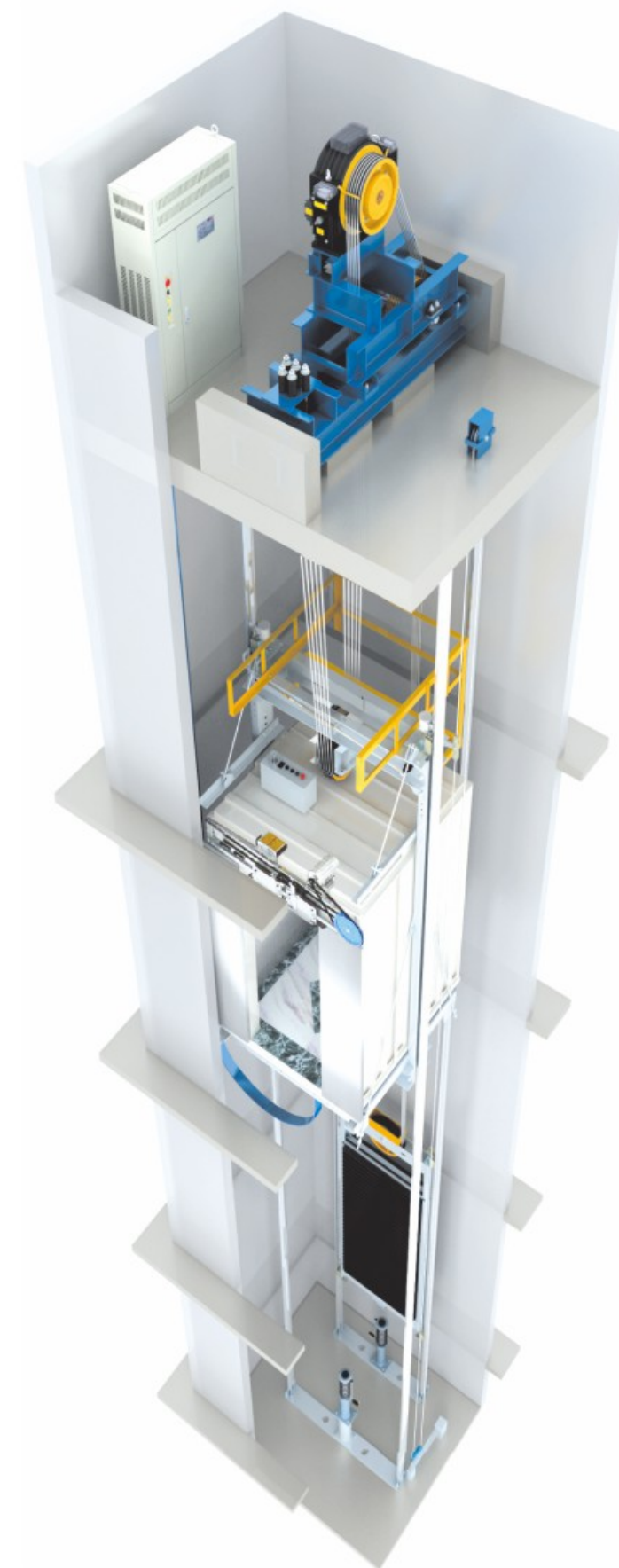

Intelligent Control System

Ensuring the intelligent elevator operation in the guarantee of security, comfortable experience.

High Performance Gearless Traction Machine

Using non mechanical transmission design of high efficiency permanent magnet synchronous, low noise, vibration small, compact, energy-saving up to 40%.

Door Protection

Waterproof grade IP 65 light curtain protection system, more than 154 light beams ensure the safety of passengers.

Comfortable Riding

Frame type car enclosure protection, secures leveling stability, adding more safety. Using inner car height 2.5m, with LED natural lighting, more optional decoration suits for VIP.

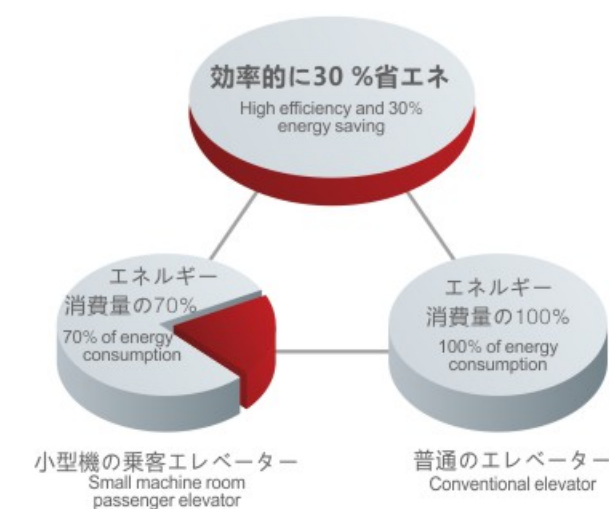

Small machine room passenger elevator Layout Shop Drawing

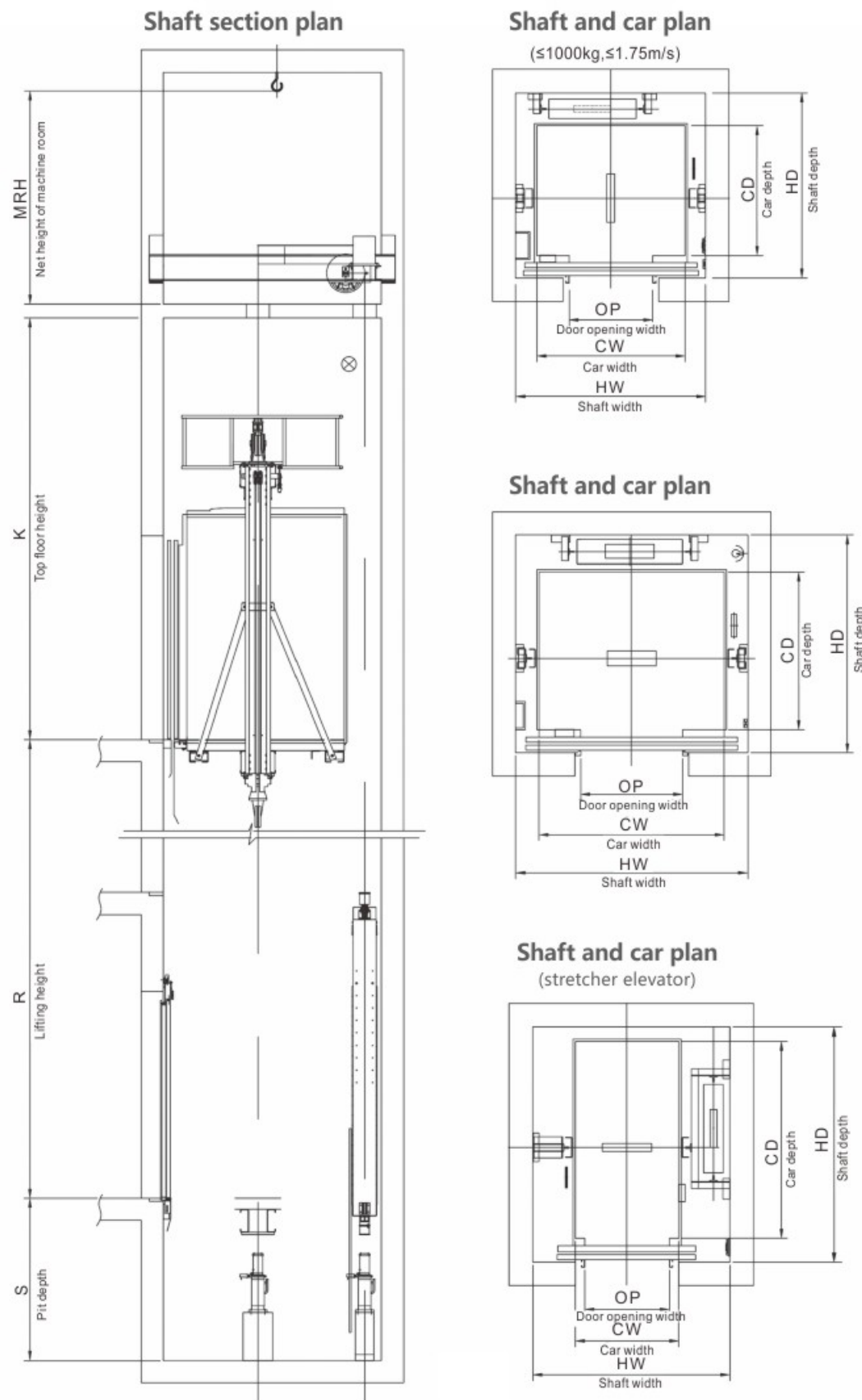

Small machine room passenger elevator Technical Specification

Load (kg)	Speed (m/s)	Max. Travel (m)	Max. Floors	Cabin Size(mm)	OP(mm)	Shaft Size(mm)	Pit	Overhead	Motor Power
				CW*CD*CH	2P CO	HW*HD	S(mm)	K (mm)	KW
450	1.0	60	20	1200*1100*2500	700*2100	1700*1750	1400	4200	4.6
	1.5/1.75	72	24				1500	4400	8.1
630	1.0	60	20	1400*1100*2500	800*2100	1850*1750	1400	4200	4.6
	1.5/1.75	72	24				1500	4400	8.1
800	1.0	60	20	1400*1350*2500	900*2100	1960*2000	1400	4200	5.5
	1.5/1.75	72	24				1500	4400	9.7
	2.0	120	40				1750	4750	11
1000	2.5	130	45	1600*1400*2500	900*2100	2050*2050	1900	4950	14.1
	1.0	60	20				1400	4200	6.7
	1.5/1.75	72	24				1500	4400	11.7
1150	2.0	120	40	2000*1350*2500	1100*2100	2500*2150	1750	4750	14.1
	2.5	130	45				1900	4950	13.4
	1.0	60	20				1550	4450	16.7
1350	1.5/1.75	90	30	2000*1500*2500	1100*2100	2500*2200	1650	4650	13.4
	2.0	120	40				1750	4750	15.4
	2.5	130	45				1900	4950	19.8
1600	1.0	60	20	2000*1700*2500	1100*2100	2500*2400	1550	4450	8.8
	1.5/1.75	90	30				1650	4650	15.4
	2.0	120	40				1750	4750	17.6
2000	2.5	130	45	2200*1850*2500	1200*2100	2700*2500	1900	4950	22
	1.0	60	20				1550	4450	10.4
	1.5/1.75	90	30				1650	4650	18.2
2500	2.0	120	40	2200*2100*2500	1200*2100	2700*2800	1750	4750	20.8
	2.5	130	45				1900	4950	26
	1.0	60	20				1550	4450	18.2
2500	1.5/1.75	90	30	2200*2100*2500	1200*2100	2700*2800	1650	4650	26
	2.0	120	40				1750	4750	30
	2.5	130	45				1900	4950	33
2500	1.0	60	20	2200*2100*2500	1200*2100	2700*2800	1550	4450	26
	1.5/1.75	90	30				1650	4650	30
	2.0	120	40				1750	4750	33
2500	2.5	130	45	2200*2100*2500	1200*2100	2700*2800	1900	4950	8



Machine roomless passenger elevator
無機房の乗客エレベーター

Machine roomless elevator incorporates the idea of environmental protection and energy saving, saving, saves building areas and raises design freedom, embodying fully green humanistic ideas. Compared with toothed gear elevators of the same weight, it saves 25% electricity and 10% building area. Elevator breaks the requirements for traditional elevators to be equipped with a machine room and provides infinite possibility to create in a limited space in modern buildings.

無機房のエレベーターの製品は環境保護の理念に精通して、省エネルギーの消費量が減少して、建築面積を節約して、設計の自由度を高めて、十分に緑色の人文の理念を体现することができます。同じ重さのレベルのある歯車エレベーターと比べて、節電は30%になり、建築面積の10%を節約し、エレベーターは伝統エレベーターを突破して、機房部屋の要求を設定しなければならない。



Space Saving

Can be flexibly applied to different types of buildings. Your building will have more stylish changes in the architectural appearance, the removal of the traditional machine room can also bring huge cost savings.

Advanced Traction Machine

Its ultra small and ultra light appearance design is applicable for machine room-less elevator shaft, and the new brake device and noise reduction processing can further minimize noise of the elevator.

Control System

Machine room-less control system can carry on the data processing more efficiently and easily meet the strict requirements for precision control and group control management.



Thin type main machine roomless passenger elevator

薄型主機ルームレスエレベーター

Thin type main machine roomless passenger elevator uphold AOYAMA ELEVATOR industry experience, including a number of industry-leading technologies and humanization designed, strategy passenger elevator. With the "thin" concept, from the host to the whole elevator structure are thin, light, improved the hoistway utilization, and reduce the overhead requirements, maximized the building space utilization.

Steel belt type machine roomless passenger elevator

スチールベルトマシンルームレス乗客エレベーター

By research market demand, AOYAMA ELEVATOR decide to provide products to our customers which has better performance, more adapt to building system. Steel belt elevators has been introduced with innovative traction technology, excellent running performance, has been wide used in residential, shopping malls, office buildings and other kinds of places.

Permanent magnet synchronous gearless steel belt host

Cooperate with composite steel belt is the Permanent magnet synchronous gearless steel belt host, this host is dedicated designed for steel belt elevators, we have made a number of technical and structure improvements, such as a host structure, brakes, etc. to make the host more safe, more efficiency, and smaller.



Compact structure creative space

The New thin host passenger elevators have innovative used the perpendicular magnetic field to greatly reduce the host thickness, only 65% of the traditional host thickness, making It possible to enhance the utilization of apace.

Compact structure creative space

Thin host, with Industry-leading electromagnetic field technology, greatly reduced the thickness of the host while optimizing the magnetic field, which makes the host mare powerful, also a number of Innovation designs have been Introduced to the passenger elevators.

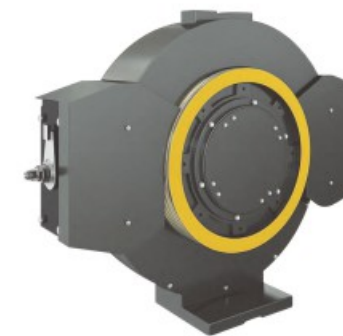

New composite steel belt

The double-side steel belt which used steel belt elevators is imported from Germany, the double-side design increase the contact area, the better driving force also used to prevent sliding. Same as the ordinary steel belt, belt surface is formed by polyurethane polymer, with no lubrication required, save the maintenance costs, and lifetime is 2-3 times than the traditional wire rope.



MRL 1, Machine roomless passenger elevator Layout Shop Drawing

MRL 1, Machine roomless passenger elevator Technical Specification

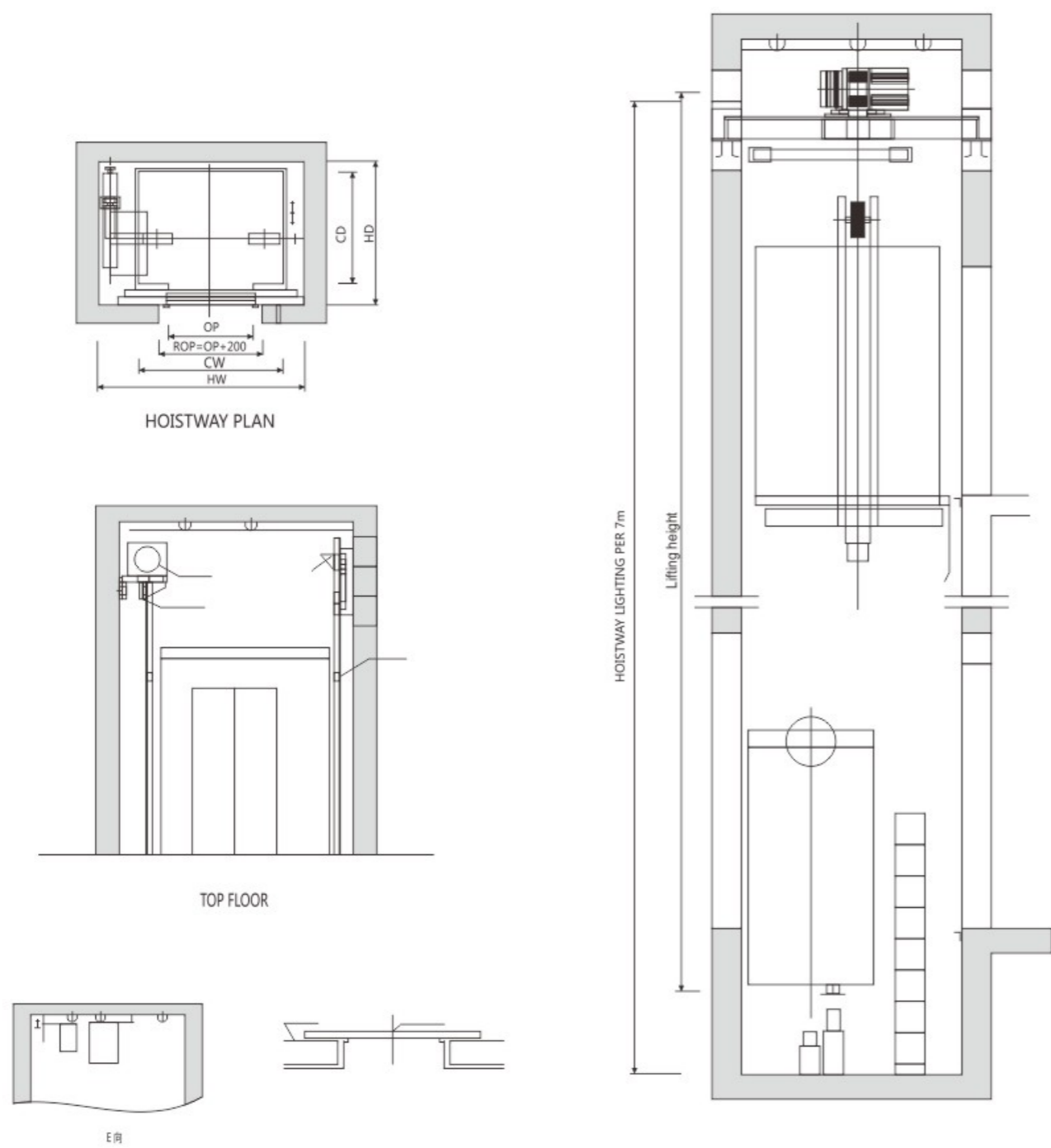

Load (kg)	Speed (m/s)	Max. Travel (m)	Max. Floors	Cabin Size(mm)	OP(mm)	Shaft Size(mm)	Pit	Overhead	Motor Power
				CW*CD*CH	2P CO	HW*HD	S(mm)	K (mm)	KW
450	1.0	60	20	1200*1100*2300	700*2100	1700*1750	1400	4200	4.6
	1.5/1.75	72	24				1500	4400	8.1
630	1.0	60	20	1400*1100*2300	800*2100	1850*1750	1400	4200	4.6
	1.5/1.75	72	24				1500	4400	8.1
800	1.0	60	20	1400*1350*2300	900*2100	1960*2000	1400	4200	5.5
	1.5/1.75	72	24				1500	4400	9.7
	2.0	120	40				1750	4750	11
1000	2.5	130	45	1600*1400*2300	900*2100	2050*2050	1900	4950	14.1
	1.0	60	20				1400	4200	6.7
	1.5/1.75	72	24				1500	4400	11.7
1150	2.0	120	40	2000*1350*2300	1100*2100	2500*2150	1750	4750	14.1
	2.5	130	45				1900	4950	13.4
	1.0	60	20				1550	4450	16.7
1350	1.5/1.75	90	30	2000*1500*2300	1100*2100	2500*2200	1650	4650	13.4
	2.0	120	40				1750	4750	15.4
	2.5	130	45				1900	4950	19.8
1600	1.0	60	20	2000*1700*2300	1100*2100	2500*2400	1550	4450	8.8
	1.5/1.75	90	30				1650	4650	15.4
	2.0	120	40				1750	4750	17.6
2000	2.5	130	45	2200*1850*2300	1200*2100	2700*2500	1900	4950	22
	1.0	60	20				1550	4450	10.4
	1.5/1.75	90	30				1650	4650	18.2
2500	2.0	120	40	2200*2100*2300	1200*2100	2700*2800	1750	4750	20.8
	2.5	130	45				1900	4950	26
	1.0	60	20				1550	4450	18.2
2500	1.5/1.75	90	30	2200*2100*2300	1200*2100	2700*2800	1650	4650	26
	2.0	120	40				1750	4750	30
	2.5	130	45				1900	4950	33
	1.0	60	20				1550	4450	26
2500	1.5/1.75	90	30	2200*2100*2300	1200*2100	2700*2800	1650	4650	30
	2.0	120	40				1750	4750	33
	2.5	130	45				1900	4950	8
	1.0	60	20				1550	4450	26

MRL 2, Belt Type Design Layout Shop Drawing

MRL 2, Belt Type Design Technical Specification

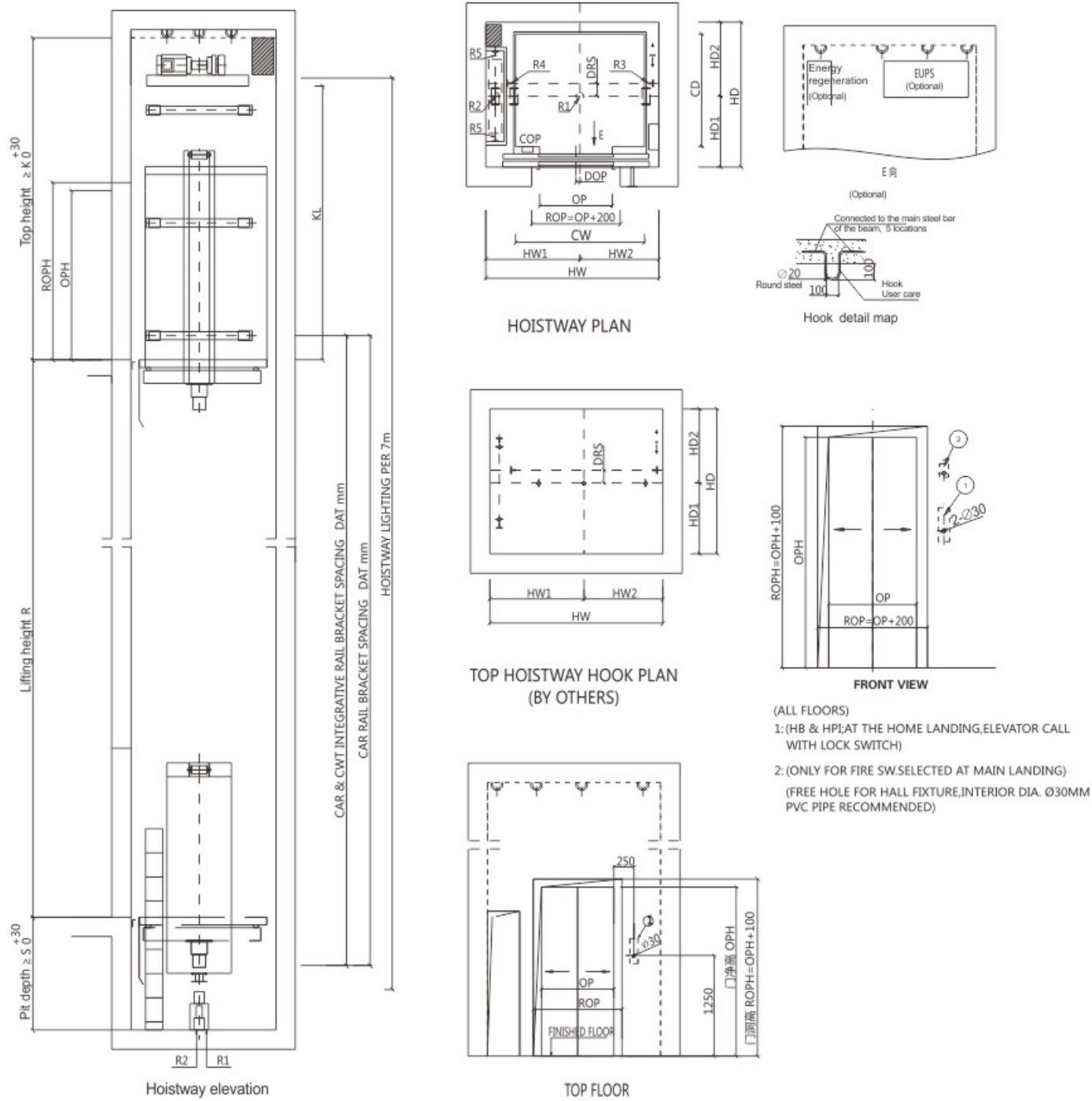

Load (kg)	Steep (m/s)	Car net size (mm)	Door net size (mm)	Hoistway net size (mm)	HW1 (mm)	HW2 (mm)	HD1 (mm)	HD2 (mm)	Pit depth (mm)	Top height (mm)	guide Pit support					Max. Floors	Max. Travel (mm)
											R1	R2	R3	R4	R5		
400	1.0	1000x1100	700x2100	1600x1500	895	705	730	770	1300	3800	50	42	23	23	17	16	50
550	1.0	1000x1400	700x2100	1600x1800	895	705	880	920	1300	3800	64	53	26	26	18	16	50
630	1.0	1100x1400	700x2100	1750x1800	945	705	880	920	1300	3800	68	55	27	27	19	16	50
680	1.0	1200x1400	800x2100	1900x1800	995	855	880	920	1300	3800	73	59	28	30	20	16	50
	3900									73	59	33	35	25	24	75	
	3950									73	59	26	37	27	32	90	
800	1.0	1350x1400	800x2100	2000x1800	1070	880	880	920	1300	3800	86	70	32	33	22	16	50
	3900									86	70	36	38	26	24	75	
	3950									86	70	39	40	29	32	90	
900	1.0	1450x1400	800x2100	2050x1800	1120	930	880	920	1300	3800	92	74	33	35	23	16	50
	3900									92	74	37	39	27	24	75	
	3950									92	74	40	42	29	32	90	
1000	1.0	1600x1400	900x2100	2200x1800	1195	1005	880	920	1300	3800	98	78	35	36	23	16	50
	3900									98	78	39	40	28	24	75	
	3950									98	78	42	43	30	32	90	
1150	1.0	1100x2100	900x2100	2100x2500	1050	1050	1230	1270	1300	3800	98	78	35	36	23	16	50
	3900									98	78	39	40	28	24	75	
	3950									98	78	42	43	30	32	90	
1150	1.0	1900x1400	1100x2100	2550x1800	1350	1200	880	920	1400	4050	112	89	54	57	30	16	50
	1500								4200	112	89	66	68	36	24	75	
	1550								4250	112	89	72	75	40	32	90	
1350	1.0	2000x1750	1100x2100	2700x1950	1450	1250	955	995	1400	4050	126	99	58	60	31	16	50
	1500								4200	126	99	69	71	37	24	75	
	1550								4250	126	99	76	78	41	32	90	
1600	1.0	2000x1750	1100x2100	2700x2150	1450	1250	1055	1095	1400	4050	140	108	61	63	33	16	50
	1500								4200	140	108	73	74	39	24	75	
	1550								4250	140	108	79	81	43	32	90	

Note: do not scale this drawing, unless otherwise stated.

MRL 3, Dish Type Motor Design Layout Shop Drawing

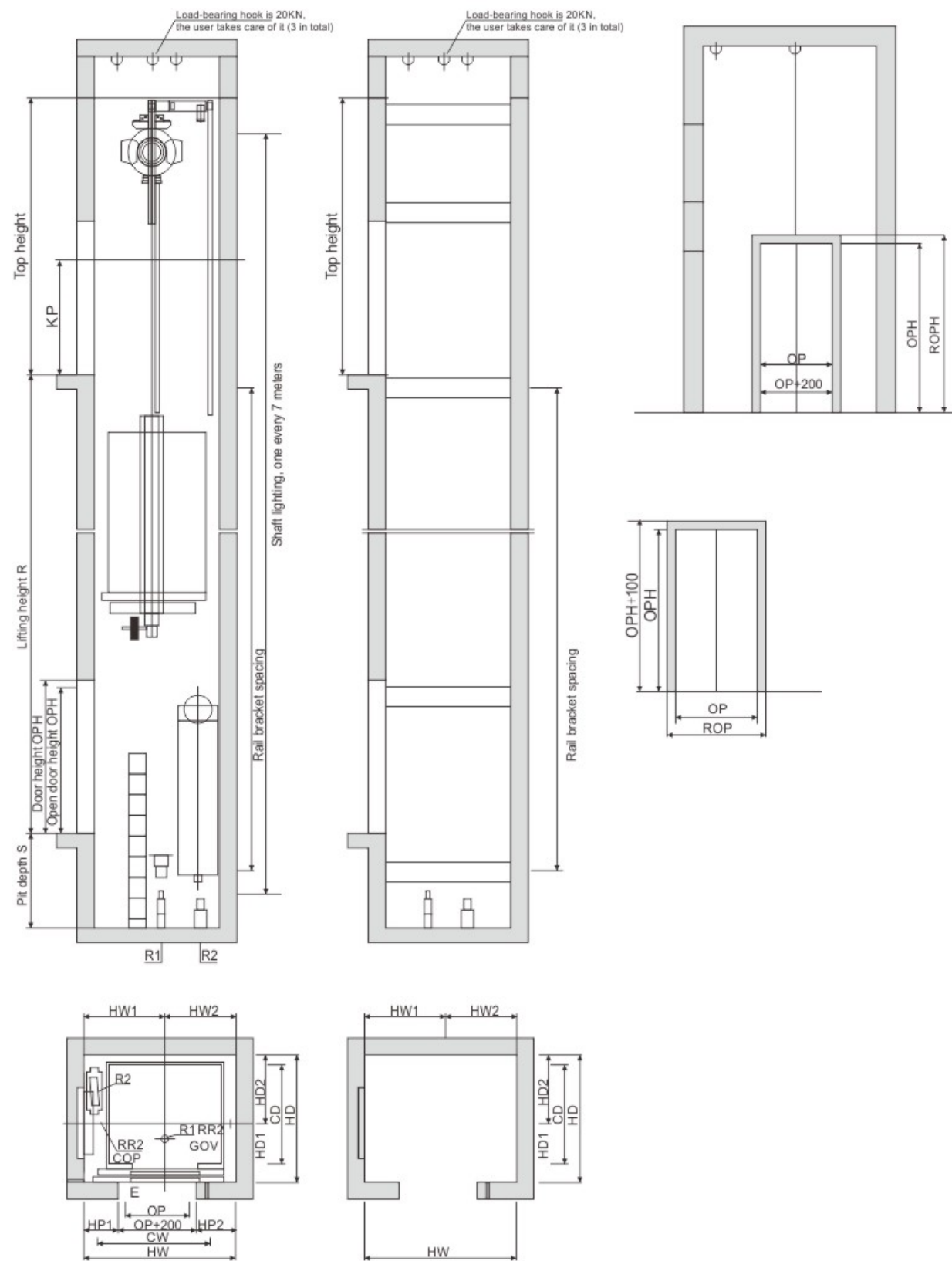

MRL 3, Dish Type Motor Design Technical Specification

Load (kg)	Steep (m/s)	Car net size (mm)	Door net size (mm)	Hoistway net size (mm)	Pit depth (mm)	Minimum top height (mm)	Maximum top height (mm)	Other positioning (mm)						guide Pit support				Max. Floors	Max. Travel (mm)
								HW1	HW2	HD1	HD2	HP1	HP2	R1	R2	RR1	RR2		
550	1	1100x1350	700x2100	1650x1775	1350	3800	4150	900	750	805	970	425	325	67	57	29	39	16	50
630	1	1100x1400		1650x1800	1350	3800	4150	900	750	830	970	425	325	73	60	30	41	16	50
680	1	1200x1400	750x2100	1750x1800	1350	3800	4150	950	800	830	970	450	350	77	63	32	43	16	50
	1.5				1500	3900	4250											24	75
800	1.75	1350x1400	800x2100	1950x1800	1500	3900	4300	1025	875	830	970	525	375	85	69	33	46	32	90
	1.5				1500	3950	4300											24	75
900	1	1500x1400	800x2100	2050x1800	1350	3800	4150	1100	950	830	970	500	450	91	73	35	48	16	50
	1.5				1500	3900	4250											24	75
1000	1.75	1600x1400	900x2100	2150x1800	1500	3900	4300	1150	1000	830	970	600	450	97	77	37	50	32	90
	1				1500	3950	4300											24	75
1000 Stretcher elevator	1	1100x2100	900x2100	2000x2500	1350	3800	4150	1000	1000	1180	1320	450	450	97	77	37	50	16	50
	1.5				1500	3900	4250											24	75
	1.75				1500	3950	4300											32	90

カスタマイズされたデザイン Customized Design

AOYAMA ELEVATOR apply different ceiling, wall and floor flexibly in the car decoration. Combined with fine technique and elaborate process, we can provide hundreds of designs and great spatial experience for you.



AC 01 Standard Decoration

- Ceiling — Hairline stainless steel, LED
- Side wall — Hairline stainless steel
- Rear wall — Hairline stainless steel
- Front wall — Hairline stainless steel
- Floor — PVC AF03
- Handrail — Hairline stainless steel HR02

AC 00 Economic type Decoration

- Ceiling — Painted steel, LED
- Side wall — Painted steel
- Rear wall — Painted steel
- Front wall — Painted steel
- Floor — PVC AF01
- Handrail — -



カスタマイズされたデザイン Customized Design

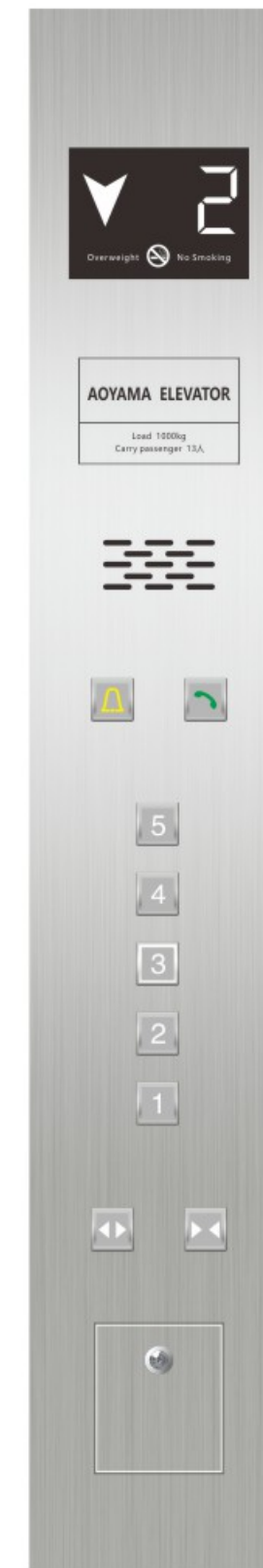

COP 01 Standard

COP Standard
Indicator: 7-inch black LCD
Panel: Hairline Stainless steel
Button: Square button, white light



10.4 inch LCD



7 inch LCD



Red dot matrix



Blue Screen

HOP Free Collection



HOP 11



HOP 13



HOP 12



HOP 14



Disabled COP 81 HOP 81



Note: pictures have been drawn by computer. It might be slightly different from actual colors. Please take real product as criterion.

Operation Panel



Hall Lantern



Note: pictures have been drawn by computer. It might be slightly different from actual colors. Please take real product as criterion.

Decoration Design

Landing door



series



AD 01

AD 02

AD 03

AD 04

AD 05



AD 06

AD 07

AD 08

AD 09

AD 10

Ceiling



series



CL 01

CL 02

CL 03

CL 04



CL 05

CL 06

CL 07

CL 08

Handrail



series



HR 01

Material: Mirror Stainless Steel tube

HR 02

Material: Circle drawing Stainless Steel tube

HR 03

Material: Mirror Stainless Steel plated in titanium gold tube



HR 04

Material: Long hairline Stainless Steel

HR 05

Material: Mirror Stainless Steel plated in titanium gold tube+wood tube

HR 06

Material: Red bronze+wood tube



HR 07

Material: Circle drawing Stainless Steel tube

HR 08

Material: Red bronze+wood tube

HR 09

Material: mirror stainless steel + wood pipe

Floor



series



AF 01

AF 02

AF 03



AF 04

AF 05

AF 06

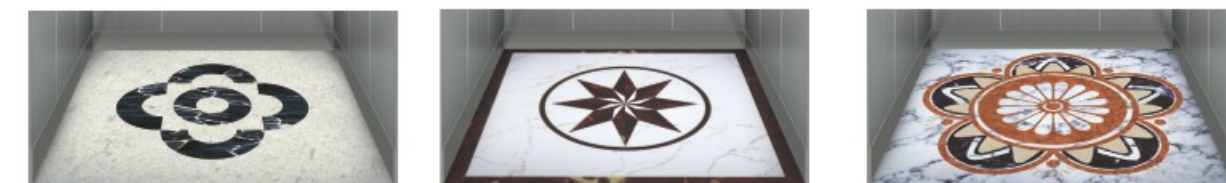

AF 07

AF 08

AF 09

Cabin Design Japanese Office Elevator Style



AC 11

Ceiling —— Mirror stainless steel roof + acrylic + LED
Side Wall —— Mirror stainless steel + hairline stainless steel
Rear Wall —— Etching + hairline stainless steel
Handrail —— HR01 circle drawing stainless steel tube
Floor —— Parquet PVC



AC 12

Ceiling —— Spray steel frame + acrylic + LED
Side Wall —— Mirror stainless steel etching plated in black titanium
Rear Wall —— Mirror stainless steel etching plated in black titanium
Floor —— Parquet PVC

Cabin Design Japanese Office Elevator Style



AC 15

Ceiling —— Mirror stainless steel roof+acrylic + LED
Side Wall —— Mirror stainless steel etching plated in black titanium
Rear Wall —— Mirror stainless steel etching plated in black titanium
Handrail —— Hr01 circle drawing stainless steel tube
Floor —— Parquet PVC



AC 16

Ceiling —— Mirror stainless steel roof + acrylic + LED
Side Wall —— Mirror stainless steel + hairline stainless steel
Rear Wall —— Mirror stainless steel + hairline stainless steel
Floor —— Non-slip stainless steel



AC 13

Ceiling —— Matte stainless steel + mirror stainless steel + LED
Side Wall —— Baking finish glass + hairline stainless steel
Rear Wall —— Baking finish glass + hairline stainless steel
Handrail —— Hairline stainless steel flat handrail
Floor —— Marble spelling



AC 14

Ceiling —— Hair brown stainless steel+translucent stone + LED
Side Wall —— Mirror stainless steel in black titanium + cellular marble
Rear Wall —— Hair brown stainless steel
Handrail —— Circle brown stainless steel tube
Floor —— Marble spelling

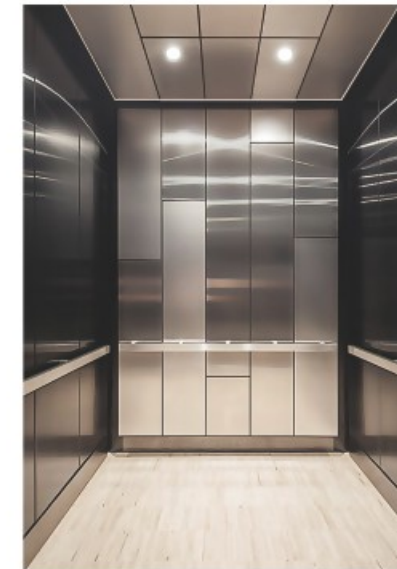

AC 17

Ceiling —— Matte stainless steel + mirror stainless steel + LED
Side Wall —— Mirror stainless steel plated in black titanium
Rear Wall —— Mirror stainless steel plated in black titanium
Handrail —— Hairline stainless steel flat handrail
Floor —— Parquet stone

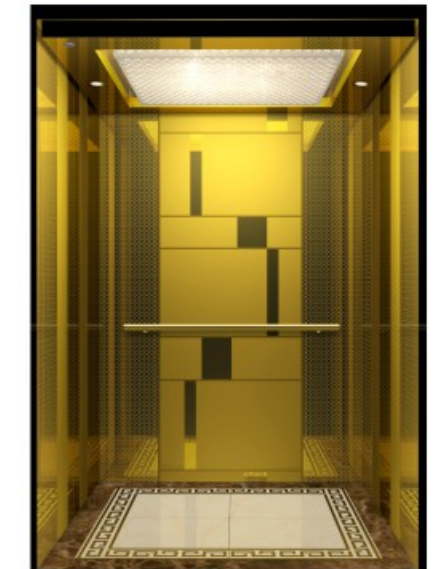

AC 18

Ceiling —— Baking varnish steel plate + acrylic lighting
Side Wall —— Mirror stainless steel titanium etching + sandblasting
Rear Wall —— Mirror stainless steel titanium etching + sandblasting
Handrail —— Titanium plating gold in mirror stainless steel tube
Floor —— Marble spelling

Cabin Design Japanese Hotel Elevator Style



AC 21

Ceiling —— Mirror stainless steel roof + acrylic + LED
Side Wall —— Mirror etching stainless steel + mirror STST
Rear Wall —— Mirror etching stainless steel + mirror STST
Handrail —— HR01 circle drawing stainless steel tube
Floor —— Marble spelling



AC 22

Ceiling —— Titanium gold stainless steel roof+acrylic + LED
Side Wall —— Titanium gold hairline stainless steel + etching STST
Rear Wall —— Titanium gold hairline stainless steel + etching STST
Floor —— Mono-stone

Cabin Design Japanese Hotel Elevator Style



AC 25

Ceiling —— Mirror rose gold stainless steel roof + acrylic + LED
Side Wall —— Mirror stainless steel etched + wood pattern fireproof plate
Rear Wall —— Mirror stainless steel etched + wood pattern fireproof plate
Floor —— Marble spelling



AC 26

Ceiling —— Mirror stainless steel frame + acrylic + LED
Side Wall —— Wood veneer, mirror stainless steel
Rear Wall —— Wood veneer, mirror stainless steel
Handrail —— HR01 circle drawing stainless steel tube
Floor —— Marble spelling



AC 23

Ceiling —— Titanium bronze stainless steel roof + acrylic + LED
Side Wall —— Bronze stainless steel + cellular marble
Rear Wall —— Etching mirror stainless steel + bronze STST
Handrail —— Red bronze + mirror light
Floor —— Marble spelling



AC 24

Ceiling —— Titanium bronze stainless steel roof + acrylic + LED
Side Wall —— Bronze stainless steel + cellular marble
Rear Wall —— Etching mirror stainless steel + bronze STST
Handrail —— Red bronze + mirror light
Floor —— Marble spelling

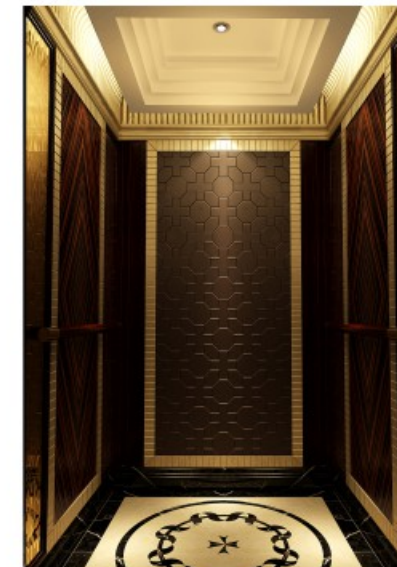

AC 27

Ceiling —— Lacquer board + sub light titanium gold stainless steel + hidden lamp + LED
Side Wall —— Titanium stainless steel etched + wood grain fireproof board
Rear Wall —— Titanium stainless steel etched + wood veneer
Handrail —— Wood + mirror titanium stainless steel
Floor —— Marble spelling

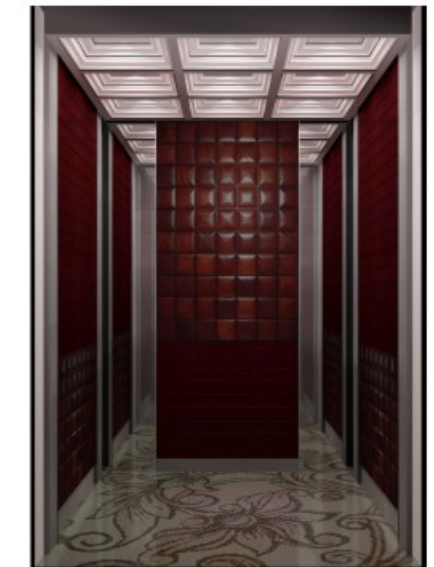

AC 28

Ceiling —— Lacquer wood frame (white, light) + LED
Side Wall —— Short hairline stainless steel + solid wood + stainless steel bar
Rear Wall —— Mirror stainless steel + solid wood + stainless steel bar
Floor —— Mosaic mosaic

Cabin Design Japanese Hotel Elevator Style



AC 31

Ceiling —— Mirror stainless steel roof + acrylic + LED
Side Wall —— Mirror stainless steel + hairline stainless steel
Rear Wall —— Etching + hairline stainless steel
Floor —— Parquet pvc



AC 32

Ceiling —— Titanium gold stainless steel roof + acrylic + LED
Side Wall —— Titanium gold hairline stainless steel + etching STST
Rear Wall —— Titanium gold hairline stainless steel + etching STST
Floor —— Mono-stone

Cabin Design Japanese Hotel Elevator Style



AC 35

Ceiling —— Mirror stainless steel roof+acrylic+led
Side Wall —— Mirror stainless steel etching plated in black titanium
Rear Wall —— Mirror stainless steel etching plated in black titanium
Handrail —— HR01 circle drawing stainless steel tube
Floor —— Parquet PVC



AC 36

Ceiling —— Rose gold mirror stainless steel + acrylic + led
Side Wal —— Rose gold mirror stainless steel + rose Gold mirror etching
Rear Wall —— Rose gold mirror stainless steel + rose Gold mirror etching
Handrail —— HR01 circle drawing stainless steel tube
Floor —— Marble spelling



AC 33

Ceiling —— Mirror stainless steel roof + acrylic + LED
Side Wall —— Mirror stainless steel etching plated in black titanium
Rear Wall —— Mirror stainless steel etching plated in black titanium
Handrail —— Hr01 circle drawing stainless steel tube
Floor —— Parquet PVC



AC 34

Ceiling —— Bronze sandblasted stainless steel + LED
Side Wall —— Bronze hairline stainless steel
Rear Wall —— Bronze hairline stainless steel + Bronze mirror
Handrail —— Bronze hairline stainless steel
Floor —— Marble spelling

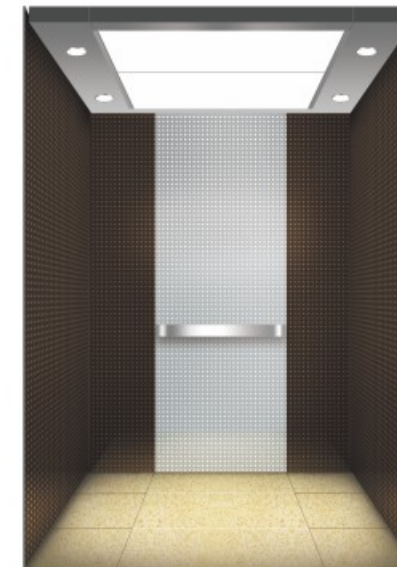

AC 37

Ceiling —— Titanium mirror stainless steel + LED
Side Wall —— Marble finish + titanium mirror stainless Steel
Rear Wall —— Marble finish + titanium mirror stainless Steel etching
Handrail —— Titanium mirror stainless steel
Floor —— Marble spelling



AC 38

Ceiling —— Lacquer board + sub light titanium gold stainless steel + hidden lamp +LED
Side Wall —— Titanium stainless steel etched + wood grain fireproof board
Rear Wall —— Titanium stainless steel etched + wood veneer
Handrail —— Wood + mirror titanium stainless steel
Floor —— Marble spelling



Villa Elevator
別荘エレベーター



AOYAMA ELEVATOR Villa elevator both in indoor or outdoor installation, no need special shaft, without special well pit, without special room, more don't need a large number of civil construction, just like any place you home appliance is convenient, not subject to any restrictions.

屋内または屋外設置の両方で青山エレベーターエレベーターシャフトのヴィラ、特別の必要でない、特別な井戸穴なしで、特別室なしで、より多くのない土木建設の多数を必要とします、どんな場所でもあなたは家電製品のように便利ですが、任意の制限はない。



Platform elevator

プラットフォームエレベーター

ALUMINUM FRAME PARAMETER

A	800	900	1000
B	800	900	1000
C	850	950	1050
D	1100	1200	1300
P	600	700	800
kg	260	320	320



Internal Configuration



Circular sightseeing series

循環型観光シリーズ

D	1600	1700
D1	1500	1600
d	1200	1300
p	700	800
KG	320	400



Applicable Occasions

Focus on high quality national brands

The following five building structures can be installed our products

①②③④⑤ the need to install the elevator shaft used, customers can also use their own metal frame or concrete and other materials in advance to establish the well.

Advantages of platform elevator

1. The real traction elevator runs smoothly;
2. Factory with panoramic sightseeing shaft, save the cost of civil engineering and trouble brain;
3. The requirements for buildings are not high, especially suitable for shallow pit, the top floor space is at the bottom, and the shaft reserved size is too small;
4. The platform elevator is light in weight and will not crush the floor. It is especially suitable for the compound structure of the stacked building with neighbors downstairs.

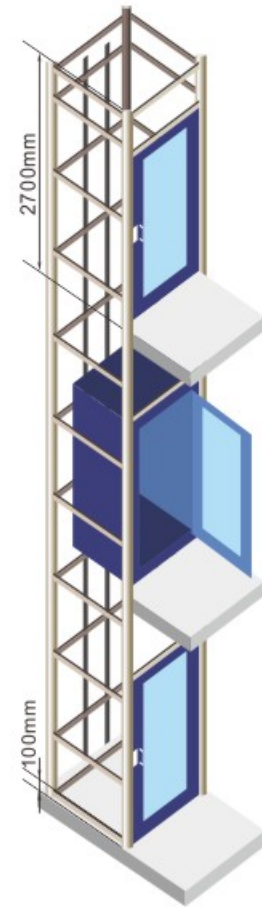
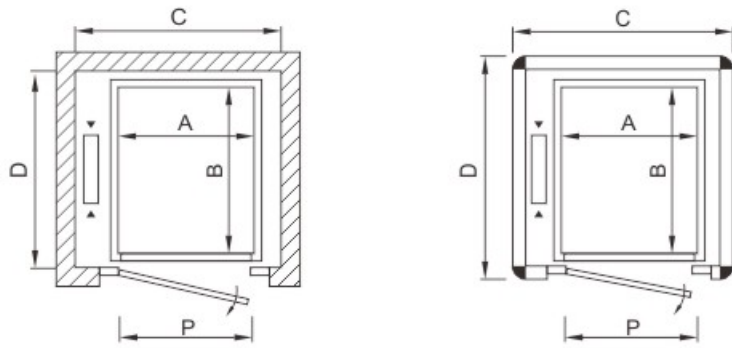

Technical Specification Traction type

Load (kg)	Speed (m/s)	Max. Travel (m)	Max. Floors	Cabin Size(mm)	OP(mm)	Shaft Size(mm)	Pit S(mm)	Overhead K (mm)	Motor Power KW
				CW*CD*CH	2P CO	HW*HD			
320	0.25	12	4	900*1200*2200	700*2100	1600*1600	350	2800	1.1
	0.4	20	6				350	2800	1.1
400	0.25	12	4	1000*1200*2200	800*2100	1700*1600	350	2800	1.1
	0.4	20	6				350	2800	1.1
	0.63	30	10				350	3000	1.9
	1.0	60	20				350	3000	2.9

HOISTWAY

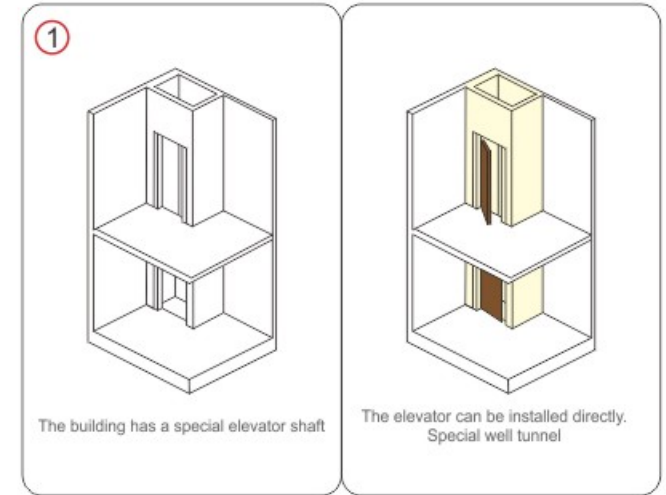

ROTATORY STAIRS

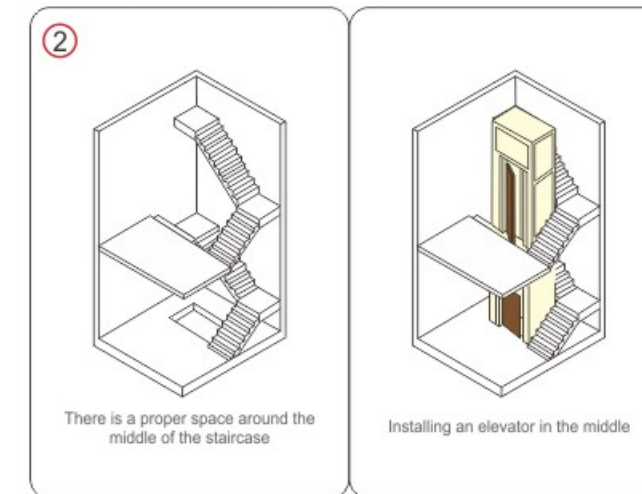

LOBBY

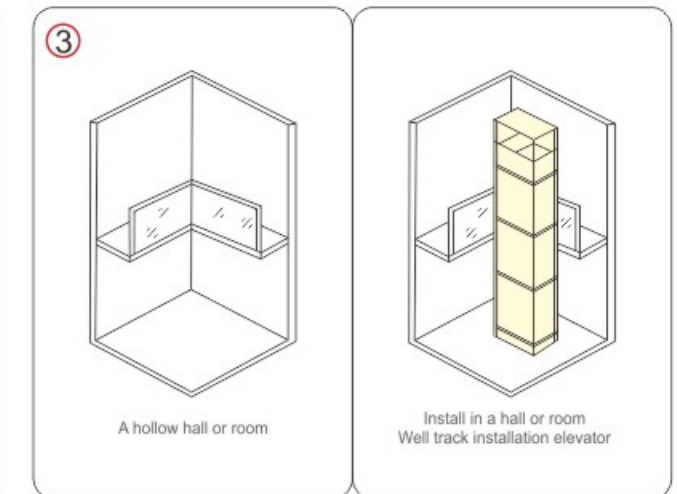

SLAB HOLE

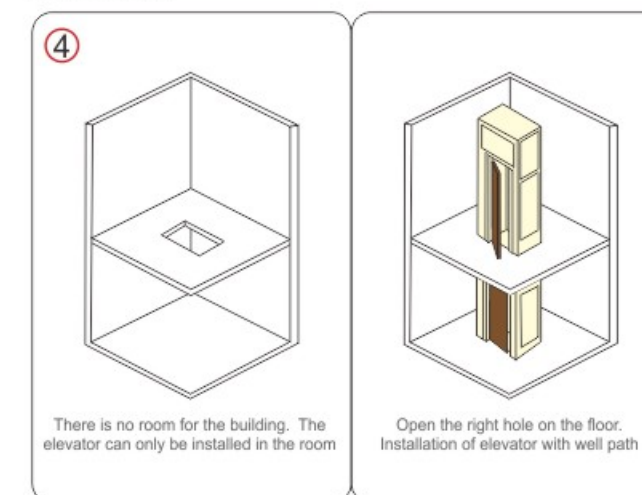

OUTSIDE

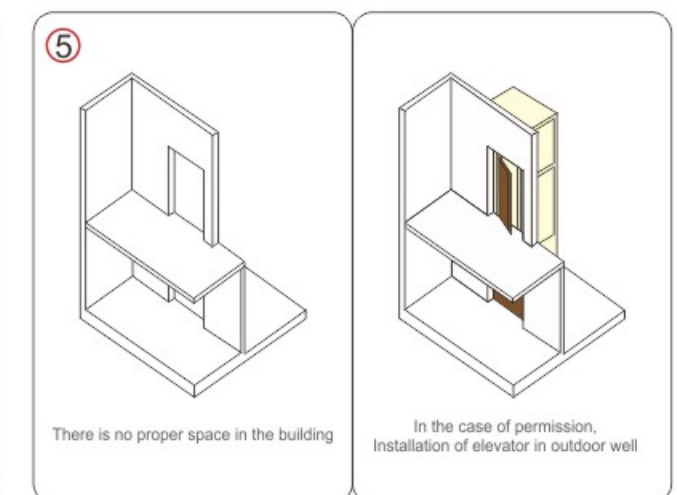

Cabin Design Japanese Villa Elevator

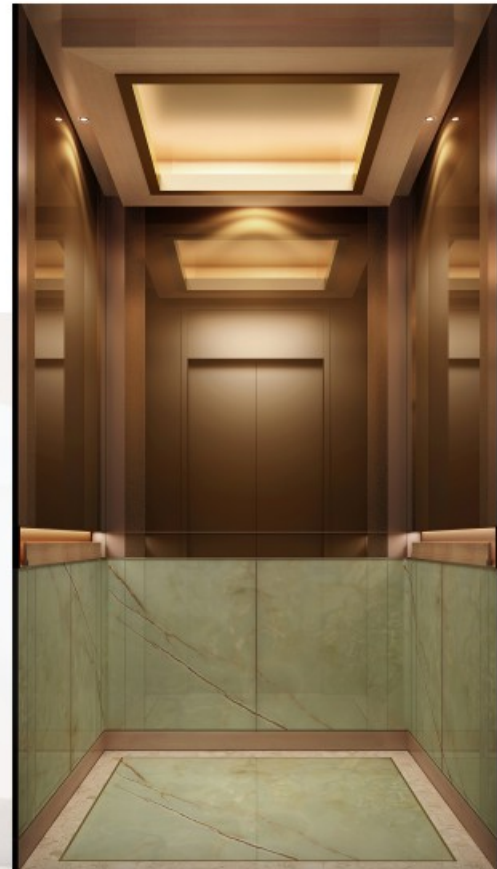

AC 55

- Ceiling — Lacquer board + bronze stainless steel bar + hidden lamp
- Side Wall — Bronze mirror stainless steel + marble + hidden lamp
- Rear Wall — Bronze mirror stainless steel + marble
- Handrail — woodiness
- Floor — Marble spelling



AC 51

- Ceiling — Hairline Stainless Steel roof+acrylic+LED
- Side Wall — Hairline Stainless Steel
- Rear Wall — Hairline Stainless Steel
- Floor — Parquet PVC



AC 52

- Ceiling — Hairline Stainless Steel roof+acrylic+LED
- Side Wall — Hairline Stainless Steel
- Rear Wall — Sightseeing glass
- Handrail — Hairline Stainless Steel
- Floor — Parquet PVC

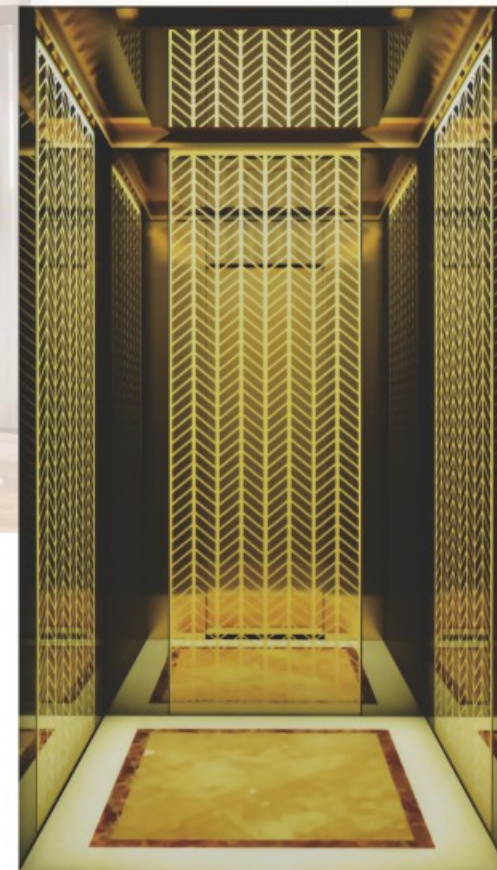

AC 56

- Mirror stainless steel + floral flute lamp belt — Ceiling
- Mirror surface etching of Black Titanium mirror + titanium gold — Side Wall
- Mirror surface etching of Black Titanium mirror + titanium gold — Rear Wall
- Parquet PVC — Floor



AC 53

- Ceiling — Mirror Stainless Steel roof+acrylic+LED
- Side Wall — Mirror Stainless Steel+Glass
- Rear Wall — Mirror Stainless Steel+Glass
- Handrail — HR01 Circle drawing stainless steel tube
- Floor — Parquet PVC



AC 54

- Ceiling — Titanium Gold Mirror Stainless Steel+LED
- Side Wall — Titanium Gold Mirror Stainless Steel+Cellular marble
- Rear Wall — Titanium Gold Etching mirror Stainless Steel
- Floor — Parquet stone



観光エレベーター

Panormic elevator

AOYAMA ELEVATOR has a variety of style, design spirit, the beautiful view of sightseeing with a transparent car design, and the beautiful appearance of the elevator and the building. The products can be widely used in large shopping malls, shopping centers, high-end Traders Hotel, senior office buildings, entertainment centers, airports, stations and other public places.

青山エレベータースタイルの様々なデザインの精神を持って、透明な車の設計による観光の美しい風景と美しい外観エレベーターの建物。製品のショッピングセンターの大型ショッピングモールに広く使用することができ、ハイエンドのシニアトレーダー・ホテル、オフィスビル、エンターテインメントセンター、空港、駅と他の公的な場所。

Cabin Design
Japanese Panoramic Elevator



AC 85

- Ceiling —— Mirror Stainless Steel roof+acrylic+LED
- Side Wall —— Hairline Stainless Steel
- Rear Wall —— Hairline Stainless Steel+Glass
- Handrail —— HR02 Circle drawing stainless steel tube
- Floor —— Parquet PVC



AC 86

- Ceiling —— Titanium Gold Mirror Stainless Steel roof+acrylic+LED
- Side Wall —— Titanium Gold Mirror Stainless Steel+Glass
- Rear Wall —— Titanium Gold Mirror Stainless Steel+Glass
- Handrail —— HR03 Circle drawing stainless steel tube
- Floor —— Parquet PVC



AC 87

- Ceiling —— Mirror Stainless Steel roof+acrylic+LED
- Side Wall —— Hairline Stainless Steel+Glass
- Rear Wall —— Hairline Stainless Steel+Glass
- Handrail —— HR02 Circle drawing stainless steel tube
- Floor —— Parquet PVC



AC 88

- Ceiling —— Mirror Stainless Steel roof+acrylic+LED
- Side Wall —— Hairline Stainless Steel
- Rear Wall —— Hairline Stainless Steel+Glass
- Handrail —— HR02 Circle drawing stainless steel tube
- Floor —— Parquet PVC

Note: pictures have been drawn by computer. It might be slightly different from actual colors. Please take real product as criterion.



青山のハイリフト Bed Elevator

AOYAMA stretcher elevator is specially designed for high-rise residential buildings with 12 floors and above, designed to accommodate stretcher products. According to the special features of the product, it has the advantages of large space, simplified equipment and simple operation, which will play an important role in high-rise residence.

青山ベッドエレベーターは、あなたの建築量のために設計することができます。高強度型材を採用して作られた輿ボックスを採用して、各種の重い担架を乗せることができ、安心して患者や大きなものを運ぶことができ、効果的に人々と物品の安全を保護します。



Tailor made safety and convenience

AOYAMA stretcher elevator can be designed for your buildings. Use high strength profile to make the car, can carry all kinds of heavy weight stretcher, ease to transport patient or large item, effectively protect people and article safety.



Human nature design is rich

Meet the needs of patients with emergency supplies, humanized design, the configuration of a complete set of advanced equipment, stable operation and comfortable. Capsules capacious and bright, not only can accommodate stretcher, but also provides convenience to people carrying large furniture.

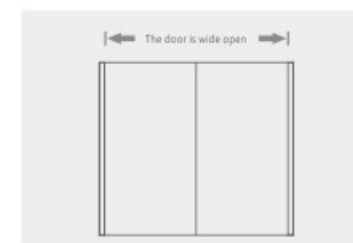

The flat layer is accurate and the door is wide open

The leveling accuracy can be controlled within a millimeter range. Open door can reach maximum width, easy stretcher free in and out.

Technical Specification

Load (kg)	Speed (m/s)	Max. Travel (m)	Max. Floors	Cabin Size(mm)	OP(mm)	Shaft Size(mm)	Pit	Overhead	Motor Power
				CW*CD*CH					
1000	1.0	60	20	1100*2100*2500	900*2100	2000*2500	1400	4200	6.7
	1.5/1.75	72	24				1500	4400	11.7
	2.0	120	40				1750	4750	14.1
	2.5	130	45				1900	4950	13.4
=1600	1.0	60	20	1400*2400*2500	1100*2100	2400*2750	1550	4450	10.4
	1.5	72	24				1650	4600	18.2
	1.75	90	30				1650	4650	18.2
	2.0	120	40				1750	4750	20.8
	2.5	130	45				1900	4950	26
2000	1.0	60	20	1550*2600*2500	1200*2100	2550*3000	1550	4450	18.2
	1.5	72	24				1650	4600	20.8
	1.75	90	30				1650	4650	26
	2.0	120	40				1750	4750	30
	2.5	130	45				1900	4950	33

貨物輸送エレベーター

Freight elevator



In the field of logistics, in the needs of factories, warehouses, shopping centers, supermarkets, stations, airports and other places, combined with the years of elevator production experience of AOYAMA ELEVATOR the production and manufacture of reliable cargo staircase products can be carried out in all kinds of bad environment. AOYAMA ELEVATOR uses 6 sets of guideways for heavy goods lift to ensure safe and reliable elevators, high strength, durability and smooth operation.

物流の分野では、工場、倉庫、ショッピングセンター、スーパー、駅、空港などのない場所の需要の中で、青山エレベーターの長年のエレベーターの生産経験を結びつけて、信頼できるエスカレーター製品を製造して、各種の悪質な環境の下で貨物輸送の仕事を行うことができます。青山エレベーターは6組のレールを採用して、重型の貨物エレベーターに使用して、エレベーターの安全に信頼できることを確保して、構造の強度が高く、経久で長持ちして、安定することなどの長所があります。



Cabin Design Cargo Elevator



Checkered Steel Plate
standard



Dot Rubber Plate



Checkered Stainless Steel Plate



Wooden



Black Plastics

Opening mode



横に足を折る
Center Opening Door

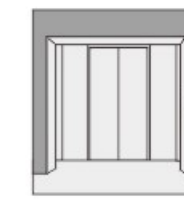

二つ折り門に分
4 Panel Center
Opening Door

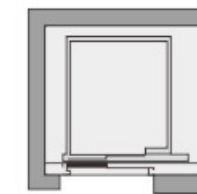

一通の扉
Sing Opening Door

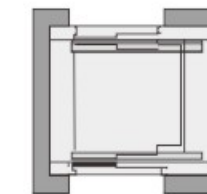

貫通門
Through Opening Door

Layout Shop Drawing

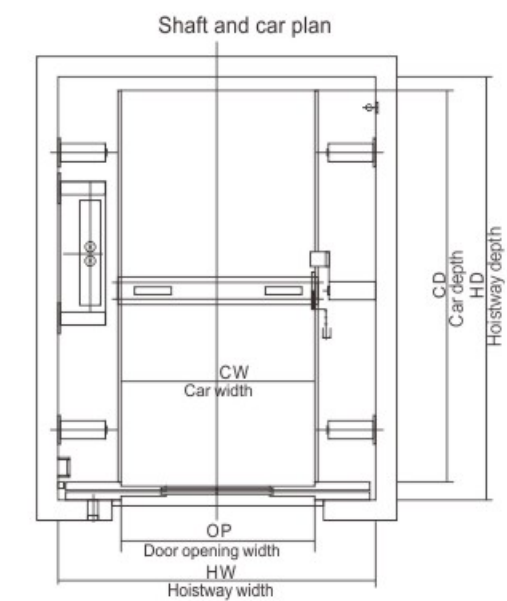

Machine Room Technical Specification

Load (kg)	Speed (m/s)	Max. Travel (m)	Max. Floors	Cabin Size(mm) CW*CD*CH	OP(mm) 2P CO	Shaft Size(mm) HW*HD	Pit		Overhead K (mm)	Motor Power KW
							S(mm)	K (mm)		
1000	0.5	24	9	1400*1600*2200	1100*2100	2450*2000	1500	4200	4200	5.5
	1.0	60	20				1500	4300		11
	1.75	72	24				1750	4500		15
2000	0.5	24	9	1700*2300*2200	1500*2100	2800*2800	1500	4200	4300	8.5
	1.0	60	20				1500	4300		15
	1.75	72	24				1650	4500		22.9
3000	0.5	24	9	2000*2800*2200	1800*2100	3300*3300	1500	4500	4500	18.5
	1.0	60	20				1500	4800		30
5000	0.25	12	5	2400*3600*2500	2400*2400	4000*4000	1500	4800	4800	15
	0.5	24	9				1500	4800		26
	1.0	60	20				1500	5100		55
6400	0.25	12	5	2600*4200*2500	2600*2400	4250*4700	1500	4800	4800	18.5
	0.5	24	9				1500	4800		30
8000	0.25	12	5	2800*4800*2500	2800*2400	4500*5300	1500	5200	5200	18.5
	0.5	24	9				1500	5200		37
12000	0.25	12	5	3500*5600*2500	3000*2400	5100*6100	1500	5200	5200	37
	0.5	24	9				1500	5200		63

Machine Room less Technical Specification

Load (kg)	Speed (m/s)	Max. Travel (m)	Max. Floors	Cabin Size(mm) CW*CD*CH	OP(mm) 2P CO	Shaft Size(mm) HW*HD	Pit		Overhead K (mm)	Motor Power KW
							S(mm)	K (mm)		
1000	0.5	24	9	1400*2600*2200	1100*2100	2450*2100	1400	4200	4200	6
	1.0	60	20				1500	4400		6
2000	0.5	24	9	1700*2300*2200	1500*2100	3000*2900	1750	4750	4750	6
	1.0	60	20				1900	4950		12.3
3000	0.5	24	9	2000*2800*2200	1800*2100	3300*3300	1550	4450	4450	10.5
	1.0	60	20				1650	4600		20.9
5000	0.25	12	5	2400*3600*2500	2400*2400	4500*4100	1650	4650	4650	16.5
	0.5	24	9				1750	4750		16.5

雑物エレベーター Dumbwaiter Elevator



AOYAMA ELEVATOR with high safety standards to create sundry elevators, with excellent quality and innovative appearance, in a variety of forms to serve all kinds of buildings. AOYAMA sundries elevator is small and flexible and simple in structure. It provides a quick, convenient and economical vertical transportation for small cargo staircase in all kinds of buildings, so as to improve people's good life.



Ground type
ウィンドウ型



Window type
ランディング型

Diversified lift car design

Many capsules design, material for the customer free to choose, the greatest degree of meet the personalized selection of architectural style and taste.

Technical Specification

Load (kg)	Speed (m/s)	Max. Travel (m)	Max. Floors	Cabin Size(mm) CW*CD*CH	OP(mm) 2P CO	Shaft Size(mm) HW*HD	Pit		Overhead K (mm)	Motor Power KW
							S(mm)	K (mm)		
100	0.4	20	6	750*750*1000	700*1000	1200*900	750	3600	3600	2.2
200	0.4	20	6	1000*1000*1200	950*1200	1450*1150	1000	3600	3600	2.2
300	0.4	20	6	1100*1100*1200	1050*1200	1550*1300	1000	3600	3600	2.2

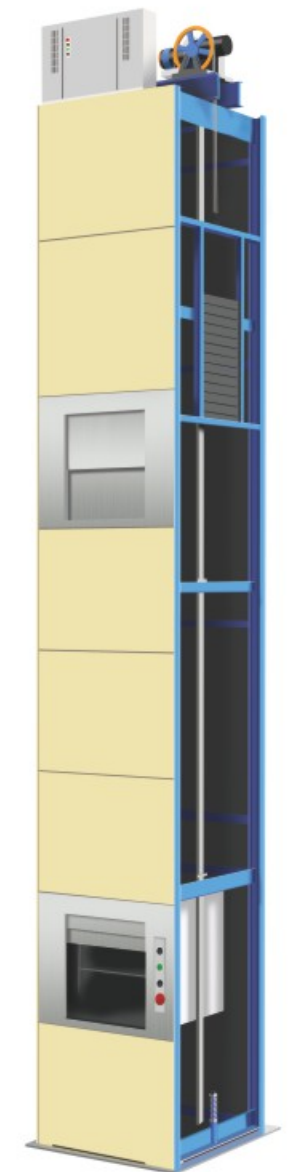

自動車エレベーター

Car Elevator

Be steady and powerful to easily achieve success

重厚な余裕が危機を抱えている

With the development of economy and the continuous improvement of people's living conditions, cars gradually enter the homes of ordinary people.

The car elevator made by AOYAMA can be widely used in parking lot, car repair factory, car dealer, underground garage and so on. It is undoubtedly the first choice for your ladder.



Technical Specification

Load (kg)	Speed (m/s)	Max. Travel (m)	Max. Floors	Cabin Size(mm)	OP(mm)	Shaft Size(mm)	Pit S(mm)	Overhead K (mm)	Motor Power KW
				CW*CD*CH	2P CO	HW*HD			
3000	0.5	24	9	2800*5650*2200	2800*2100	4600*6130	1400	4500	18.5
	1.0	60	20				1650	4800	30
5000	0.25	12	5	3400*5800*2500	3000*2400	5300*6300	1650	5200	15
	0.5	24	9				1650	5200	26

Elevator Function

Control function

- VVVF drive
- VVVF drive for door operator
- Well and floor distance self-tuning
- Power on re-leveling
- Micro-touch button for car
- Car arrival chime
- Intelligent call service
- Pre-opening
- The second car operation panel
- Remote monitoring and control
- Special floor priority service
- Non-service floor setting
- Duplex control
- Group supervision function
- Up peak service (for elevator group)
- Down peak service (for elevator group)
- Lunch time service (for elevator group)
- VIP service (for elevator group)
- Continuity of service (for elevator group)
- Automatic floor support (for elevator group)

Information function

- Emergency car lighting
- Car ventilation light automatically shut off
- Repeated door closing
- Automatically adjust door opening time
- Reopen with hall call
- Express door closing
- Car stop and door open
- Pre-load start

Information function

- Full collective selective control
- Full-load bypass
- Main floor shut off
- Self diagnosis of breakdown
- Five-way communication
- Car alarm
- Floor and direction indicator in the car
- Floor and direction indicator at hall
- Voice announcement
- Car LCD display
- Traffic flow management (for elevator group)
- Decentralized standby

Safety function

- Light curtain
- Overload holding stop
- Anti- nuisance
- Traction-resistant rope sliding
- Start protection control
- Inspection operation
- Inching operation
- Safety stop
- Terminal forced deceleration protection
- Up/down limit and terminal protection
- Over speed protection device
- Up over speed protection
- Power failure emergency leveling device
- Fire emergency return
- Fireman running
- UCMP

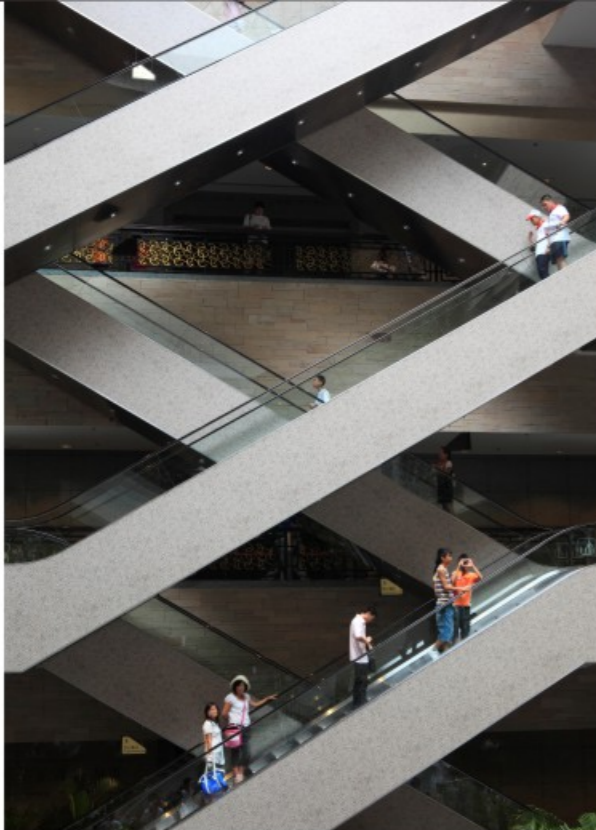

Escalator エスカレーター

青山の自動手すりは工業の技術を引き取って、それは機械の部品の精度の上の何もない人間性の安全な設計で技術の先進的で、穏やかで快適で、安全で信頼できる、省エネの環境保護などの設計理念を解釈しました。青山の自動手すりは都市の交通のために最も完備している解決案に力を尽くして、マーケット、地下鉄、列車の駅などの公共の場所と大流量の商業場所のために、楽しみに満ちたエスカレーターの運送計画を提供して、都市の交通渋滞を緩和します。



AOYAMA escalator leads the industrial technology, its omnipresent humanized security design on the precision of mechanical parts perfectly interprets the design concept of advanced technology, smooth and comfortable, safe and reliable, energy saving and environmental protection.

AOYAMA escalator is committed to providing the most perfect solutions for urban transportation, providing a fun escalator delivery scheme for public places, such as shopping malls, subway, railway stations, and other public places, in order to alleviate urban traffic congestion.

Simple and comfortable enjoy comfortable shopping

簡単に快適で、楽しいショッピングを楽しむ

Adopting the advanced control system and reducer, high-class driven chain and precise installation technology to ensure the comfort of the product.

先進的な制御システムおよび減速器を採用し、優良品質の駆動チェーンと精密なインストール技術を採用して、製品の快適性を保証します。





Moving walk 自動歩道

青山の自動人歩道はその卓越した性能、柔軟なデザインスタイルと経済実用的な特徴によって、多くの取引先のニーズを満足させることができる。安全、快適、省エネ技術の向上、製品のアップグレードの全体的なベースを向上させました。青山移動歩行機は、空港、デパート、スーパー、遊園地などに広く使われ、都市の交通に明るい色を加えている。

AOYAMA mobile sidewalk, with its excellent performance, flexible design style and economical and practical features, can well meet the needs of different customers. The improvement of safety, comfort and energy saving technology has improved the overall pace of product upgrading. AOYAMA mobile walker is widely used in airports, shopping malls, supermarkets, playgrounds and other places, and is committed to add bright colors to urban traffic.

Safe and stable 安全で信頼できる

The anti-skid slot design of the short pedal surface possesses good non-skid property and makes the usage safe and comfortable. The extreme small angle of inclination of the broach ensures the shopping cart easily pushed to the walkway. The short pedal directly connects with the transmission chain, ensuring the moving walk operates more smooth and steady and the product maintenance easier.

テクノロジー
Practical

エレガント
Elegant

実用的である
Science

Standard Configuration

標準構成



Micro Computer Board Technology

The application of computer technology, has the feature of a stronger expansion, more refined fault detection function, and more security performance.

Standard Configuration

標準構成



Water Level Detection Sensor (outdoor Standard)

Install water level detection sensor out of the machine room, which can automatically detect the water level, and found the water trouble.

Temperature Controller (outdoor Standard)

When the environment temperature is too low, the elevator system will automatically start heating device to ensure the normal operation of the escalator and also a comfortable environment for passengers.

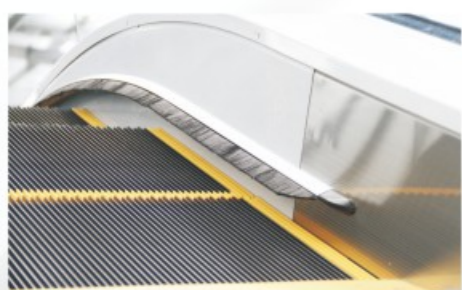

Skirt Panel Brush

The skirt panel brush is installed on the both sides of the skirt panel above the steps and prevent things or shoes from touching the skirt panel and prevent something from entering into the gap between skirt and steps.



Emergency Stop Button

On an emergency, press the button, the escalator/moving walk will immediately stop running.

Optional Configuration

オプション設定

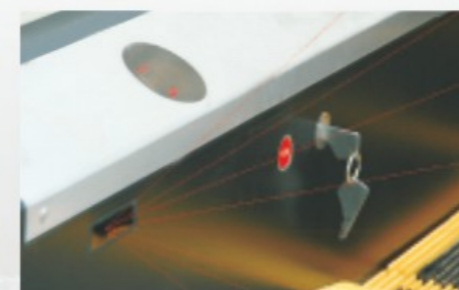

Automatic Start stop

The infrared ray sensor which is near the floor plate can detect the passenger that enter into the floor plate. Then it will automatically start the operation. After all the passengers leave, it will automatically stop the operation again in order to save the energy loss. Scanning sensor and traditional guide rod are available for your choice.



Handrail Inlet Protection

The handrail inlet protection prevents objects or limbs from getting roped into the handrail re-circulation.



Automatic Oiling

The handrail inlet protection prevents objects or limbs from getting roped into the handrail recirculation.



Skirt Panel Illumination

The skirt panel lighting along the step running track is an elegant way to comply with the required illumination. At the same time, they are an architectural element emphasizing the escalators and giving passengers a pleasant and safe feeling.



Out Cladding

Special design of the escalator outside decoration, cover the whole escalator truss, perfect to create the escalator luxury

Handrail Colors

手すりの色



Balustrade panel colors

欄干のパネルの色

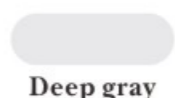
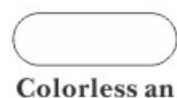
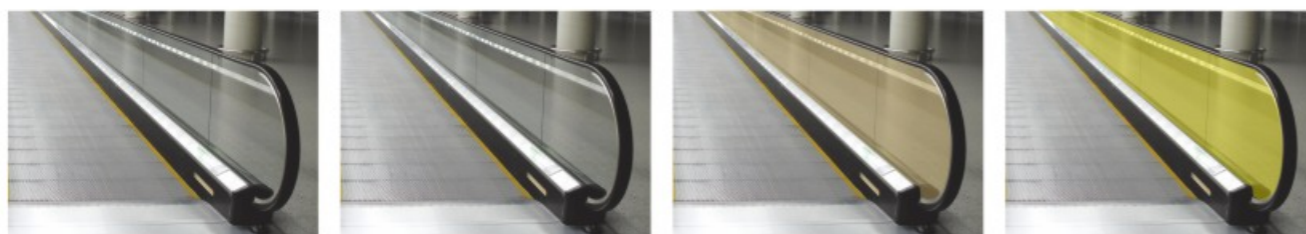

Handrail illumination

手すり照明



White

Blue

Red

Layout specifications and dimensions

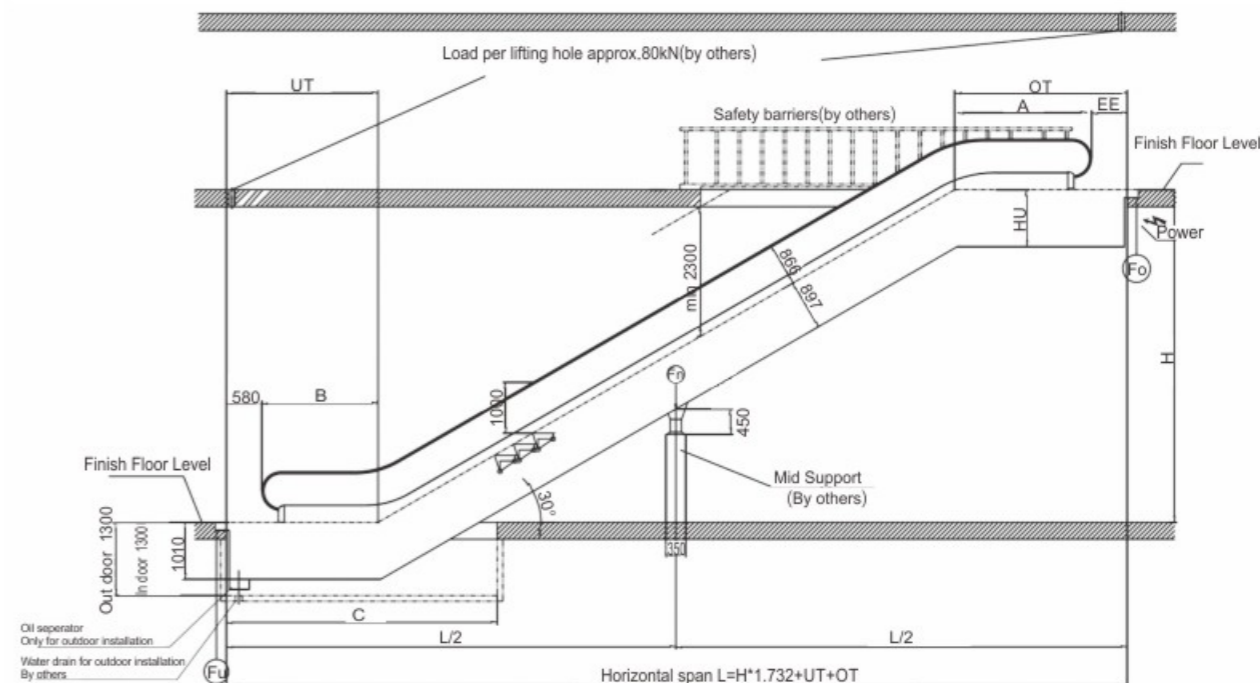

*The figure above is for max rise 8000mm

MSC 30 Degree

Horizontal step	Step Width	OT	UT	EE	
2steps	1000	indoor	2567	2198	580
		semi-outdoor / outdoor	2567	2198	580
	800	indoor	2567	2198	580
		semi-outdoor / outdoor	2817	2198	830
	600	indoor	2984	2198	997
		semi-outdoor / outdoor	2984	2198	997
3steps	1000	indoor	3057	2688	580
		semi-outdoor / outdoor	3057	2688	580
	800	indoor	3057	2688	580
		semi-outdoor / outdoor	3307	2688	830
	600	indoor	3474	2688	997
		semi-outdoor / outdoor	3474	2688	997

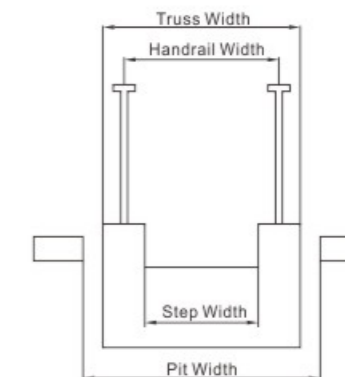

unit: mm

Type	600Step	800Step	1000Step
Step Width	600	800	1000
Handrail Width	838	1038	1238
Truss Width	1140	1340	1540
Pit Width	1200	1400	1600

MSC 30 Degree Motor Power

Motor Power(kw)	HU		Travel Height (H:mm)		
	indoor	semi-outdoor / outdoor	600Step	800Step	1000Step
5.5	1010	1010	H≤5720	H≤4440	H≤3630
7.5	1010	1010	H≤8000	H≤6310	H≤5150
11	1010	1200	-	H≤8000	H≤7500
15	1010	1200	-	-	H≤8000

Type	Horizontal Step	A	B	C
MSC	2steps	1987	1618	4300
	3steps	2477	2108	4800

*The 3 horizontal steps is needed if the travel height is over 6000mm.

*The standard pit depth is 1100mm. For outdoor escalator, the pit depth is 1300mm.

Layout specifications and dimensions

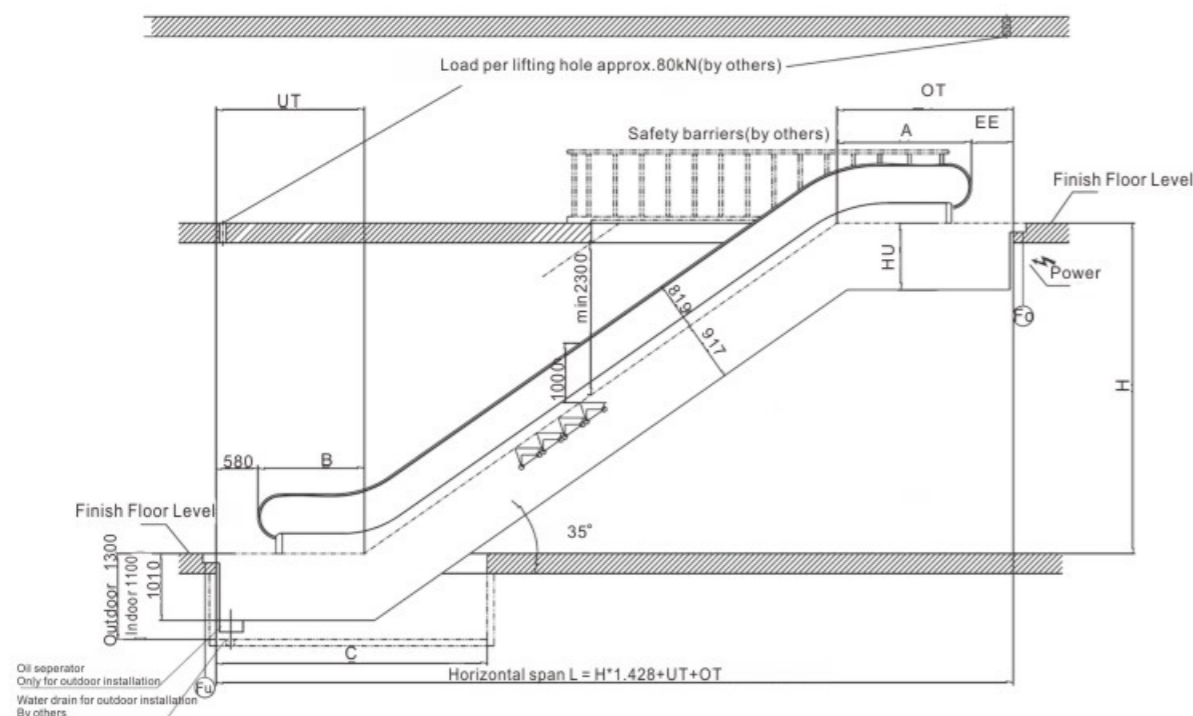

MSC 35 Degree

unit: mm

Horizontal step	Step Width	OT	UT	EE	
2steps	1000	indoor	2663	2242	580
		semi-outdoor / outdoor	2263	2242	580
	800	indoor	2263	2242	580
		semi-outdoor / outdoor	2913	2242	830
	600	indoor	3080	2242	997
		semi-outdoor / outdoor	3080	2242	997
3steps	1000	indoor	3153	2732	580
		semi-outdoor / outdoor	3153	2732	580
	800	indoor	3153	2732	580
		semi-outdoor / outdoor	3403	2732	830
	600	indoor	3570	2732	997
		semi-outdoor / outdoor	3570	2732	997

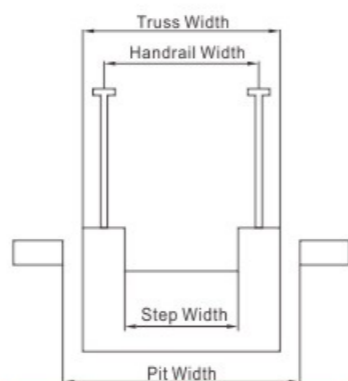

unit: mm

Type	600Step	800Step	1000Step
Step Width	600	800	1000
Handrail Width	838	1038	1238
Truss Width	1140	1340	1540
Pit Width	1200	1400	1600

MSC 35 Degree Motor Power

Motor Power(kw)	HU		Travel Height (H:mm)		
	indoor	semi-outdoor / outdoor	600Step	800Step	1000Step
5.5	1010	1010	H≤6000	H≤4890	H≤3990
7.5	1010	1010	-	H≤6000	H≤5660
11	1010	1200	-	-	H≤6000

*The 3 horizontal steps is needed if the travel height is over 6000mm.

*The standard pit depth is 1100mm. For outdoor escalator, the pit depth is 1300mm.

MAC 12Degree with upper horizontal pallet

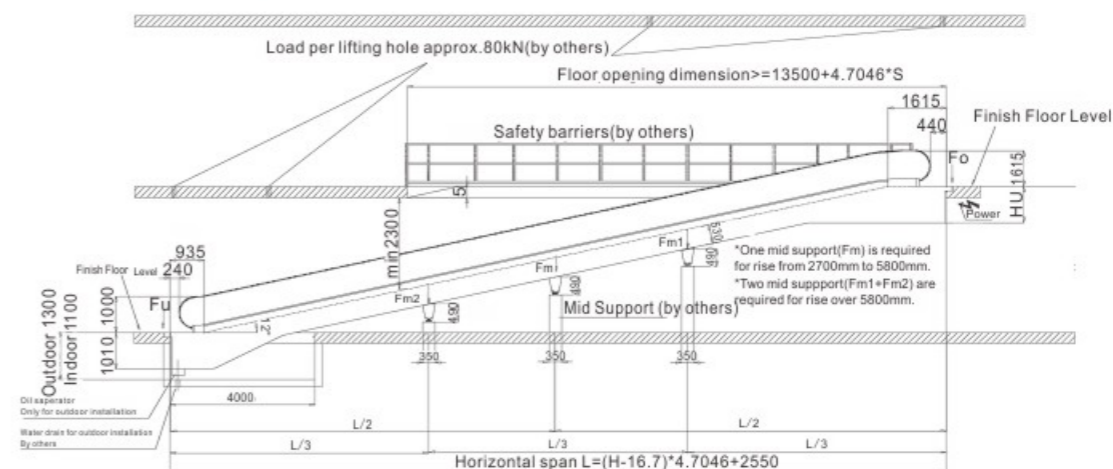

MAC 12Degree with upper & lower horizontal pallet

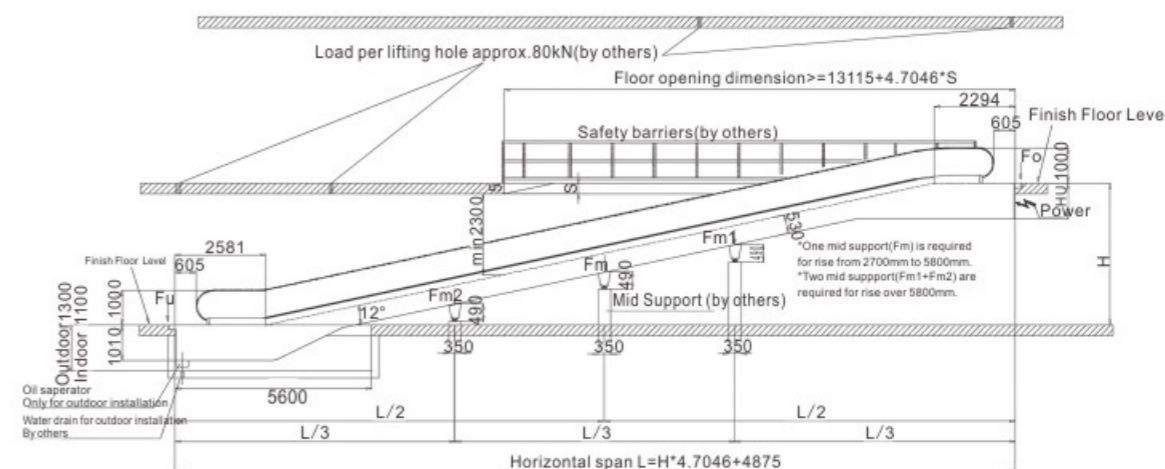

unit: mm

Type	800Pallet	1000Pallet
Step Width	800	1000
Handrail Width	1038	1238
Truss Width	1340	1540
Pit Width	1400	1600

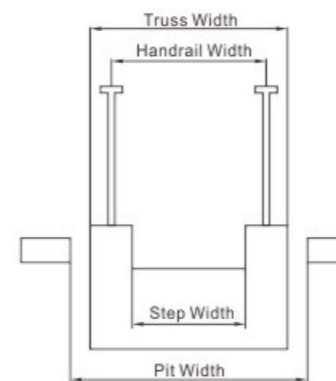

MSC 12 Degree Motor Power

Motor Power(kw)	HU		Rise (H:mm)	
	indoor	outdoor	800Pallet	1000Pallet
5.5	1010	1200	H≤3300	H≤2700
8	1010	1200	H≤4700	H≤3800
11	1010	1200	H≤6000	H≤5700
15	1200	1200	-	H≤6000

Modernization Packages

Extend your elevator and escalator's lifespan

With the average age of buildings growing steadily in many countries, property owners increasingly need to invest in modernizing their people transportation systems. At AOYAMA ELEVATOR, we're proud to work with customers worldwide to prolong their system's lifespan, safely, intelligently and cost effectively.

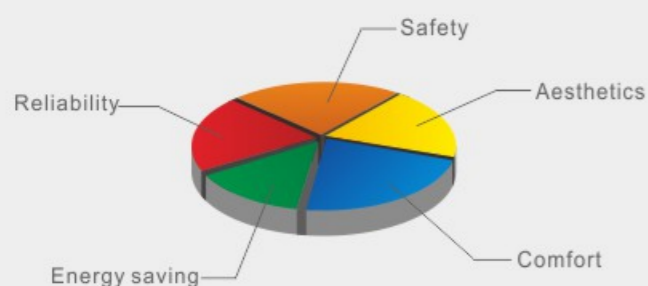

All of our modernization packages and upgrades have specially been designed with the idea of making these five aspects match together. Considering the highest standards on safety, reliability, energy saving, comfort and aesthetic globally is the only way to ensure the best modernization solution for your elevator.

When is it time to modernize?

It's time to consider modernizing if any of these are true...

- You're unsure if the elevator complies with current code and safety standards
- People wait too long in the lobby
- Passengers complain about poor floor leveling, ride comfort or noise
- The building's use has changed since the elevator was first installed
- The elevator
 - is more than 10 years old
 - looks worn and out-of-date
 - gets overcrowded
 - shuts down often
 - has a negative effect on rental and property values

Modernization products

Base on existing device, minimum changes bring maximum upgrades. AOYAMA ELEVATOR modernization solutions offer both full modernization packages and device upgrades to match your building requirements.

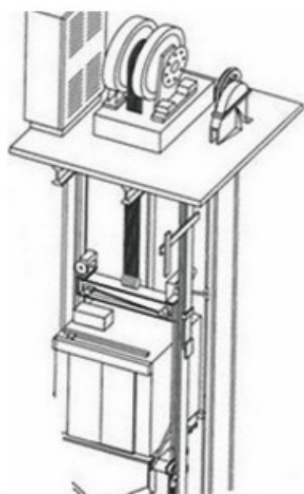

System Modernization



Device Upgrade

System modernization

Keep the good quality mechanical parts and change old out-dated electrical components by new electrical control system with latest technology; upgrade main parts of the elevator, such as controller, drive and brake system, door control system. You will have the function and value of a new elevator with less expense and no big impact to your building's normal usage.



Device upgrade

Improve elevator/escalator Safety, Comfort, and Aesthetics by adding on additional devices or upgrade certain parts of existing equipment. Even you elevators are relatively new, it's also good for you to consider Device Upgrade to increase your elevators and building's value and catch up with extremely high technology development speed.

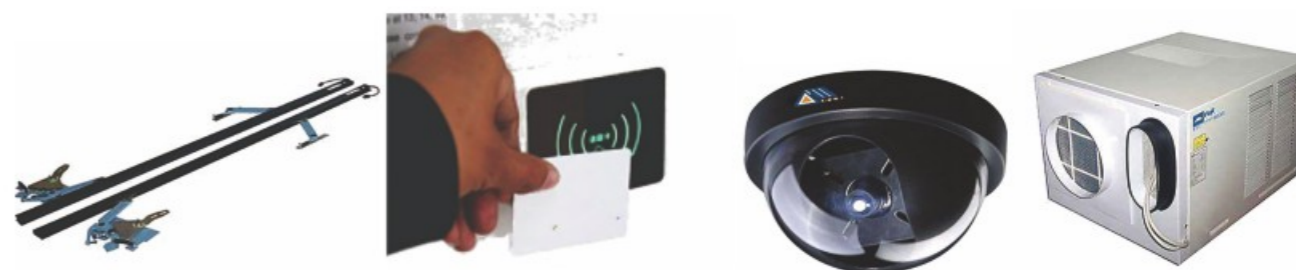

Escalator modernization

Installed as an upgrade on existing escalators, the Variable Frequency Control System adjusts the escalator's speed and output according to detected traffic flows.



1. Reliable modernization solution

The latest technology Variable Frequency Control System existing on new escalators has been specially developed as an upgrade on existing units. This guarantees the highest quality standards for your existing escalator.

2. High flexibility

The system is designed to match with existing escalator units.

3. Energy saving

In allowing the adjustment in speed according to traffic flow, the Variable Frequency Control System can reduce the energy consumption of your escalator up to 50%.

Reference Projects

Location: Japan
Project Name: NAGOYA STATION



Location: Japan
Project Name: NAGOYA Library



Location: Japan
Project Name: NAGOYA Airport
Specs: Elevator Modernization



Location: Pakistan
Project Name: Saddar Hotel4 units
high class decoration lifts



Location: Dubai UAE
Project Name: AL MESHWAR RESTAURANT



Location: Philippines
Project Name: 12AYMNEW-0218-PJG-HOSPITAL



Location: Russia
Project Name: Черниговская 9



Location: Russia
Project Name: Овчиникова 15



Location: Russia
Project Name: Малая



Location: Kazakhstan
Project Name: Astana Sani



Location: Pakistan
Project Name: Gold Tower



Location: Kazakhstan
Project Name: Айналайын

Reference Projects



▲ Location: Panama
Project Name: Hilton Hotel



▲ iland factories Myanmar
12 units Cargo lifts



▲ Location: UAE
Project Name: Ranya Sports Council, Dubai



▲ Location: Bahrain
Project Name: Ajoor furniture, zinj



▲ Location: Cambodia
Project Name: Vatanac kompong thom



▲ Location: India
Project Name: Government Building



▲ Location: Ukraine
Project Name: Residence



▲ Location: Azerbaijan
Project Name: Railway station 24-15



▲ Location: Indonesia
Project Name: Sekolah pasat bogor school



▲ Location: Georgia
Project Name: SABURTALO PALACE



▲ Location: Azerbaijan
Project Name: Railway station 24-1



▲ Location: Azerbaijan
Project Name: Railway station 24-21



▲ Location: Kenya
Project Name: West Hospital Nairobi

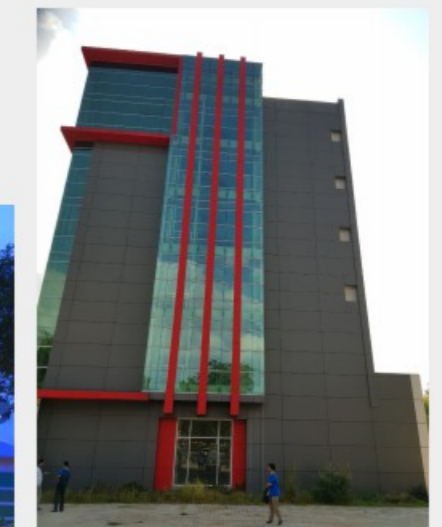

▲ Location: Indonesia
Project Name: Jambi Hospital

Concentration 一心不乱にする

With professional service attitude, has always been to customer demand for the service core.
専門的なサービス態度で、常に顧客需要をサービスの中心とします。

Intimate 心を張る

24 hours online service, always waiting for the safety of the customer.
24時間オンラインサービスは、クライアントの安全を待っています。

Peace of mind 安心する

Regularly send technicians to test the elevator, to provide you with the most professional maintenance.
定期的に技術者を派遣してエレベーターを検査して、最も専門的な保養を提供します。

サービス



We have been in your side
あなたのおそばに



AOYAMA ELEVATOR believe connecting you and me, not only our products, more of our services, our service begins with the customer's lift shaft, until the product's useful life for life, as long as you need, we will at any time.

青山エレベーターと私は信じて接続するだけでなく、当社の製品は、我々のサービスの多くは、我々のサービスは、顧客のリフト軸で始まり、生活用製品の寿命まで、あなたが必要とする限り、我々は少しの時間である。

